

Chalice 74

The IP65 and fire-rated downlight completes our Chalice range with a smaller size for demanding environments

- IP65 from below for installation in moist environments like bathrooms
- Tool-free and flexible installation with completely detachable connector box
- Exchangeable lens and bezel for customisation on site



Photographs, line drawings and photometric data are representative only. For specific product detail please select an individual product.

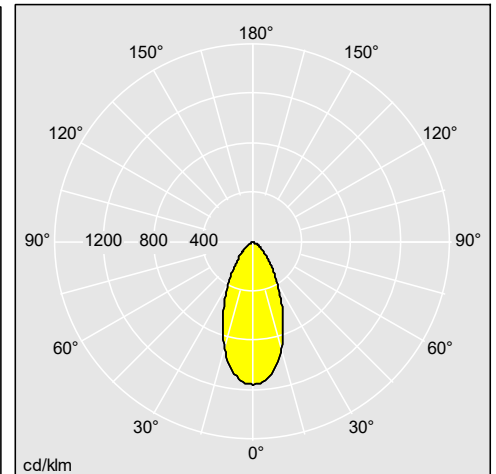
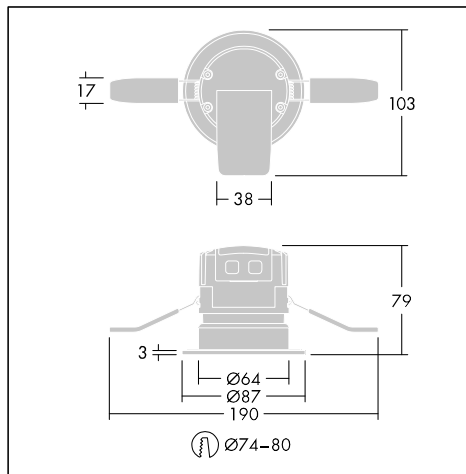

96631506

Material/Finish

Housing/body material: steel with aluminium heatsink covered with a PC cap

Lens material: PMMA

Bezel material: die-cast aluminium

Bezel finish: matt white, gloss white, matt black, chrome, brushed aluminium

Installation/Mounting

Chalice 74 can be installed directly from the box into a wide range of ceiling types including thicknesses from 1mm – 25mm.

Equipped with a detachable connector which allows an easy and toolfree pre-wiring via push-fit terminal block.

Specification

To specify state:

A ceiling recessed, fire-rated, LED downlight with IP65 as standard.

Fixed output. Correlated colour temperature is 3000/4000K with CRI>80 and a chromaticity tolerance of 3.

Luminaire is available in two lumen packages 550lm and 900lm.

Overall height <100mm and a cut out of 74-80mm. Lifetime is 50,000 hours (L70) at Ta 25°C.

As Thorn Chalice 74

Chalice 74

Ordering Guide

Description	ILCOS Code	Socket	Wt (kg)	SAP Code
Chalice 74				
CHAL 74 LED900-830 WFL IP65 WHM	LED		0,4	96631505
CHAL 74 LED900-840 WFL IP65 WHM	LED		0,4	96631506
CHAL 74 LED550-830 WFL IP65 WHM	LED		0,3	96631503
CHAL 74 LED550-840 WFL IP65 WHM	LED		0,3	96631504
Chalice 74 attachments				
CHAL 74 TRIM WHM			0,04	96631507
CHAL 74 TRIM CR			0,04	96631508
CHAL 74 TRIM AL			0,04	96631509
CHAL 74 TRIM WH			0,04	96631510
CHAL 74 TRIM BKM			0,04	96631511
CHAL 74 LENS WFL			0,02	96631513
CHAL 74 LENS WW			0,02	96631515
CHAL 74 LENS FL			0,02	96631516