

Technical Information

Design

BSEN40, PD6547: 2004+A1: 2009 (No Sign)
 Load Class B
 Deflection Class 3

Head load - See Table

Finish

Galvanised to BSEN 1461:2009 + 1.) External Root

Welding

In accordance with BSEN1011
 Procedures to BSEN ISO 15614-1:2017
 Welders qualified to BSEN ISO 9606-1:2017

* Maximum design head load based on wind loading region with orientation of bracket/ luminaire(s) being on the same plane as door

Approximate Column Weight: 360.4kg

Maximum Loading Including Bracket		
Wind Loading Region	Terrain Category	Weight/Area
Extra Light	I	180kg/1.62m ²
	II	205kg/1.9m ²
Light	I	155kg/1.42m ²
	II	180kg/1.67m ²
Medium	I	140kg/1.25m ²
	II	165kg/1.55m ²
Heavy	I	115kg/1.1m ²
	II	150kg/1.42m ²
Extra Heavy	I	85kg/0.79m ²
	II	110kg/1.02m ²

3rd Angle

96632713

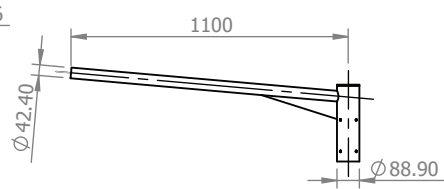
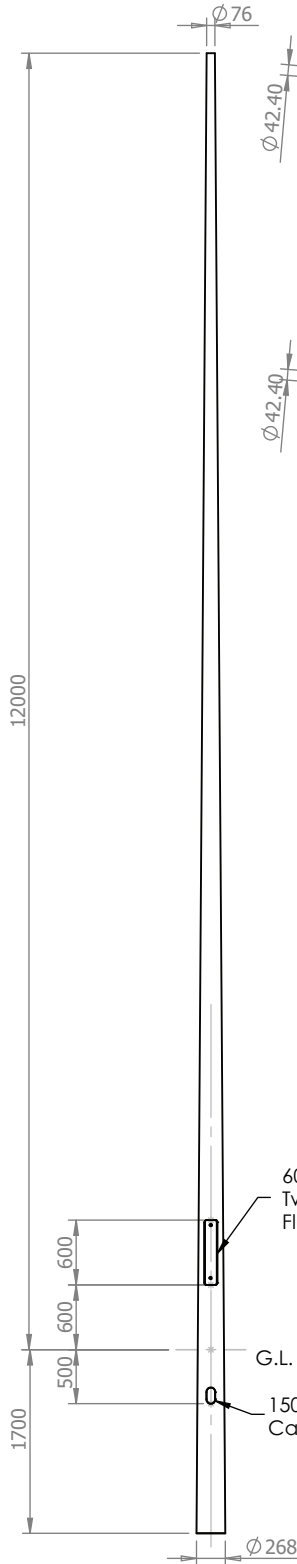

96632718 - Single Arm Bracket
 Approx Weight: 7.15kg

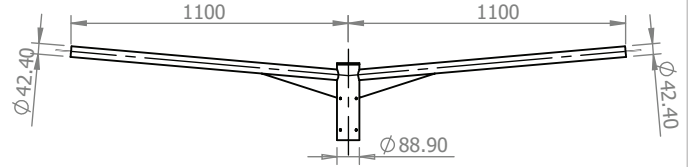

96632719 - Twin Arm Bracket
 Approx Weight: 11.19kg

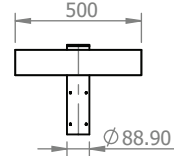

96632720 - Single Flood Light Bracket
 Approx Weight: 6.22kg

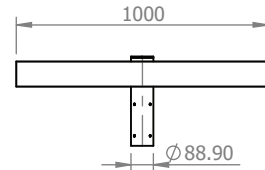

96632721 - Double/Quad Flood Light Bracket
 Approx Weight: 9.62kg

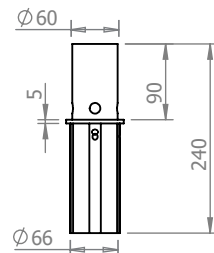

96633562 - 60mm Post Top Adaptor
 Approx Weight: 1kg



Title

12 Metre Tapered/Conical Root Mounted Post Top Column

Drg No. 36026-3

Scale:1:70
 Sheet 1 of 1

Notes

All dimensions in millimetres unless stated otherwise.

When Multiple views are shown 3rd Angle Projection is assumed.