

Technical Information



Design

BSEN40, PD6547: 2004+A1: 2009 (No Sign)
Load Class B
Deflection Class 3

Head load - See Table

Finish

Galvanised to BSEN 1461:2022

Welding

In accordance with BSEN1011
Procedures to BSEN ISO 15614-1:2017
Welders qualified to BSEN ISO 9606-1:2017

* Maximum design head load based on wind loading region with orientation of bracket/luminaire(s) being on the same plane as door

Approximate Column Weight: 225kg

96632712

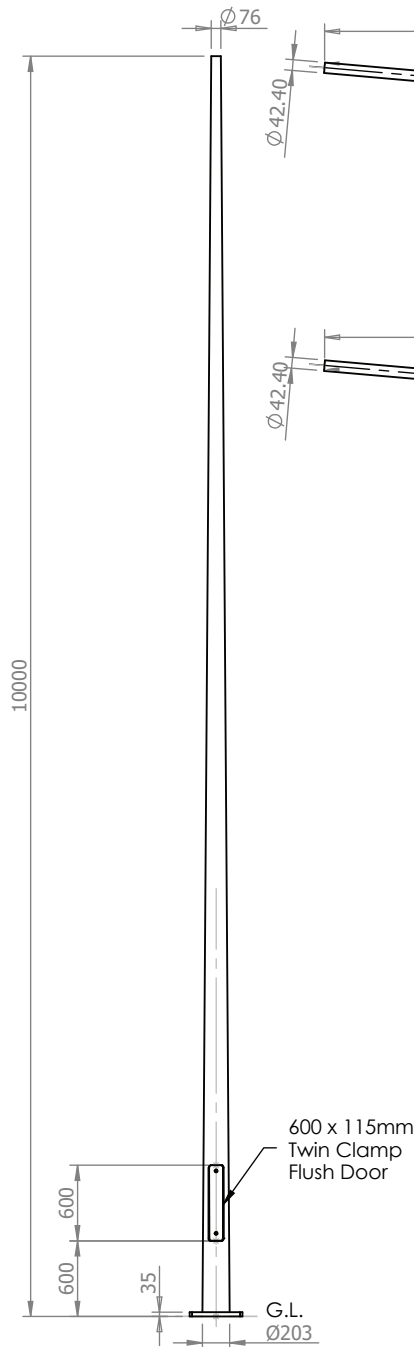

Maximum Loading Including Bracket		
Wind Loading Region	Terrain Category	Weight/Area
Extra Light	I	140kg/1.41m ²
	II	160kg/1.67m ²
Light	I	125kg/1.22m ²
	II	145kg/1.48m ²
Medium	I	115kg/1.06m ²
	II	135kg/1.35m ²
Heavy	I	115kg/1.26m ²
	II	110kg/1.04m ²
Extra Heavy	I	80kg/0.62m ²
	II	90kg/0.88m ²

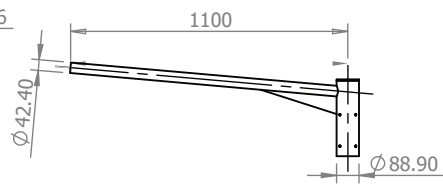
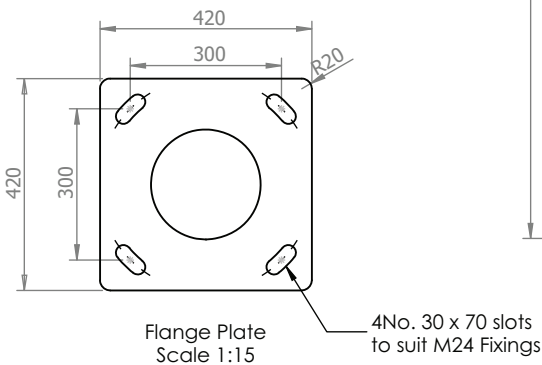

96632718 - Single Arm Bracket
Approx Weight: 7.15kg

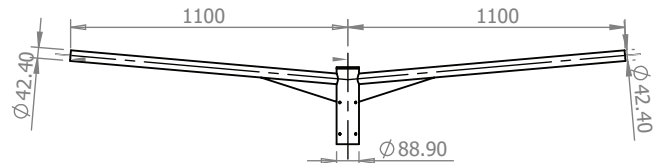

96632719 - Twin Arm Bracket
Approx Weight: 11.19kg

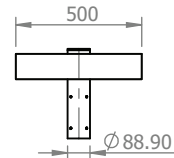

96632720 - Single Flood Light Bracket
Approx Weight: 6.22kg

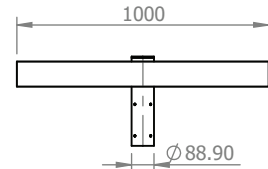

96632721 - Double/Quad Flood Light Bracket
Approx Weight: 9.62kg

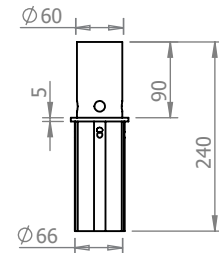

96633562 - 60mm Post Top Adaptor
Approx Weight: 1kg



Title

10 Metre Tapered/Conical Flange Plated Post Top Column

Drg No. 49378-0

Scale:1:60
Sheet 1 of 1

Notes

All dimensions in millimetres unless stated otherwise.

When Multiple views are shown 3rd Angle Projection is assumed.