

**UK** Installation instructions

**FI** Asennusohje

**LV** Instalācijas instrukcija

**DE** Montageanleitung

**FR** Notice de montage

**NO** Monteringsanvisning

**CZ** Montážní návod

**HU** Szerelési útmutató

**PL** Instrukcja montażu

**DK** Monteringsvejledning

**IT** Istruzioni di montaggio

**SE** Installationsanvisning

**EE** Paigaldusjuhend

**LT** Montavimo Instrukcijos

**RU** ИНСТРУКЦИЯ ПО МОНТАЖУ

TYPE : ALG5 - BW - 264L

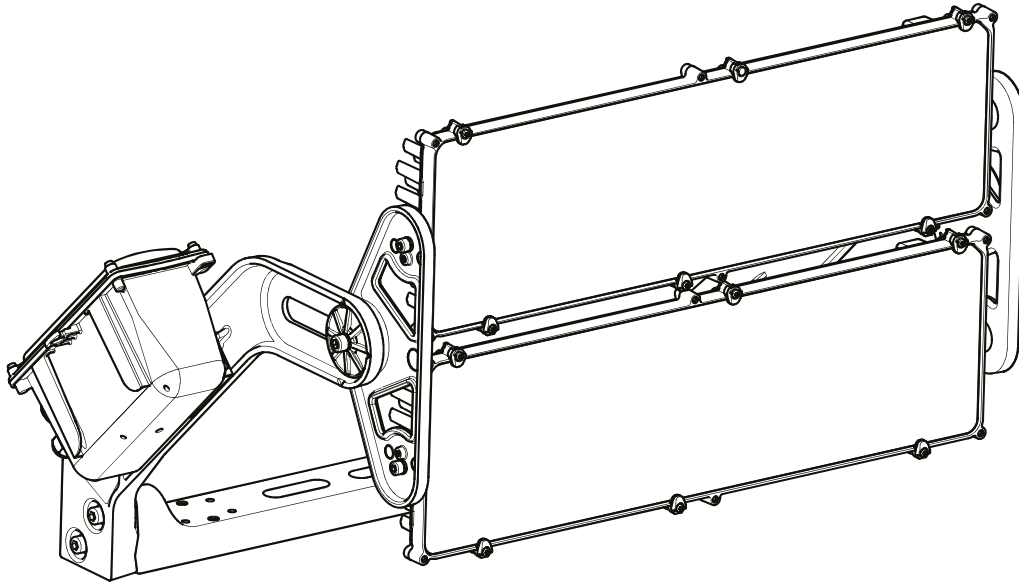

IP66 / IK08

= 23.7 kg

The luminaire with clear optic should be positioned so that prolonged staring into the luminaire at a distance <2m is not expected

Caution, risk of electric shock  
Danger, risque de chocs électriques

**Extreme caution** : Do not connect any LED CONNECTION wire (high voltage) inside NTC connector !! It could result in a critical failure and damage irreversibly the ALTIS luminaire

The light source contained in this luminaire shall only be replaced by the manufacturer or his service agent or a similar qualified person.

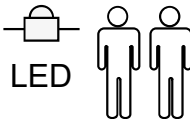

LED



CLASS I

19/30/36



4/8/10

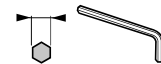

T20/T26

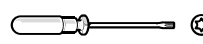

SZ3

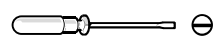

1

GEAR BOX : ALG5 GB LE

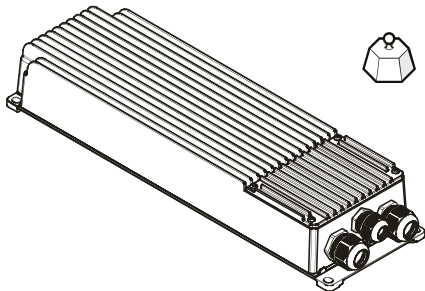

= 5.4 kg

ALG5 GB 2 CH

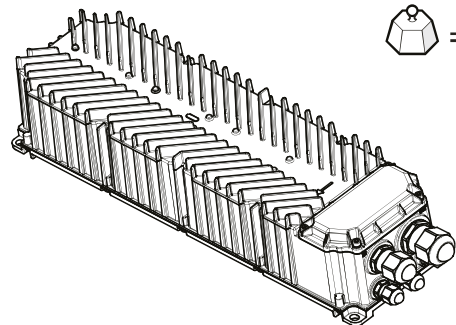

= 6.1 kg

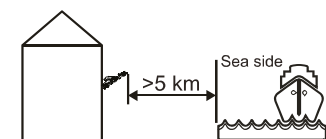

IP66 / IK08

IP66 / IK08

## ALG5 - BW - 264L

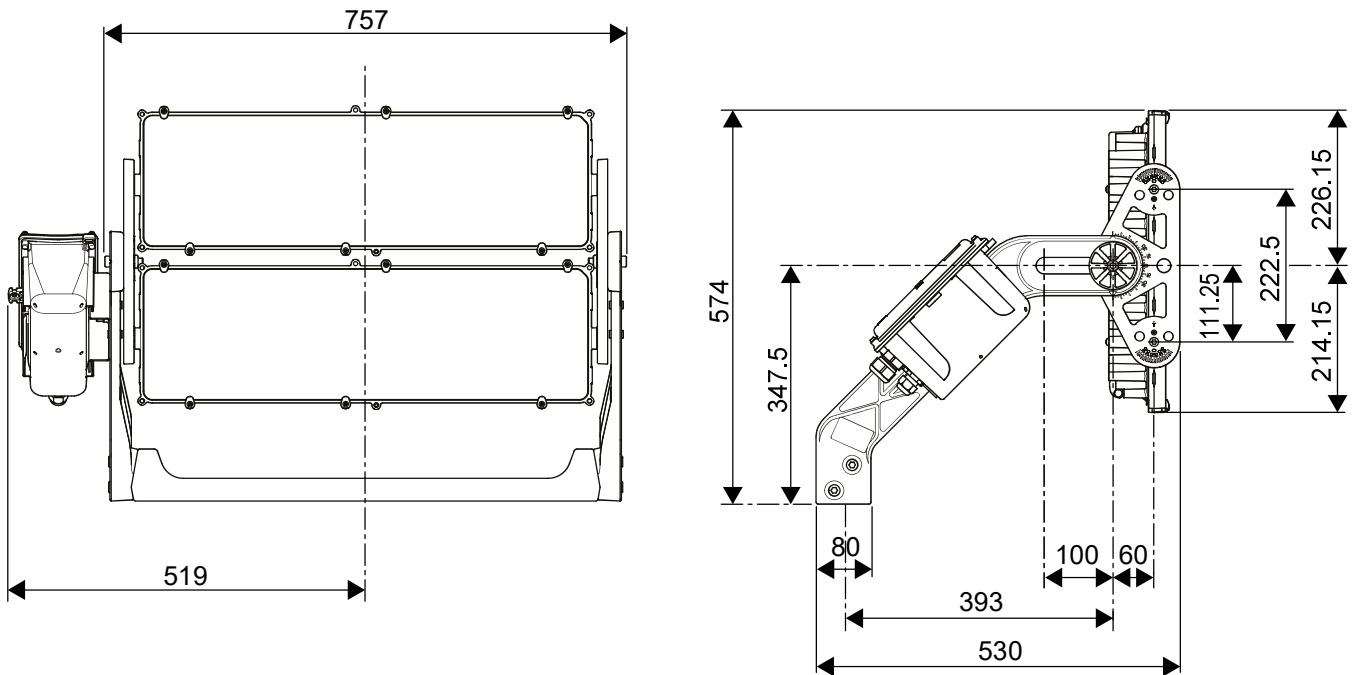

		$S_C X 0^\circ$ *	$S_C X 15^\circ$ *	$S_C X 45^\circ$ *	$S_C X 65^\circ$ *	$S_C X 90^\circ$ *
ALG5	2 BRICKS	0.152	0.181	0.294	0.347	0.366

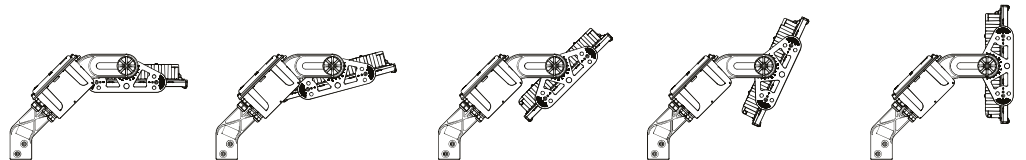

\* These data refer to the worst case at indicated angle

## ALG5 GB LE

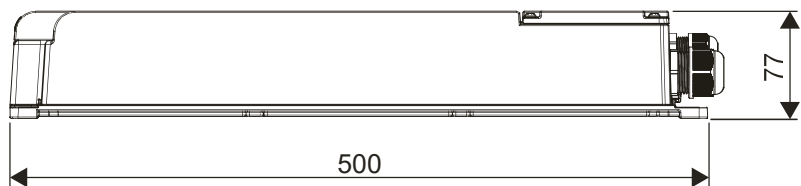
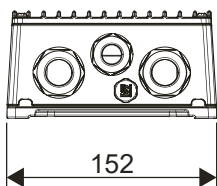

## ALG5 GB 2CH

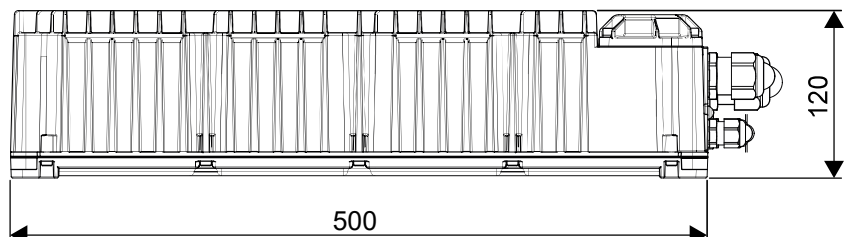
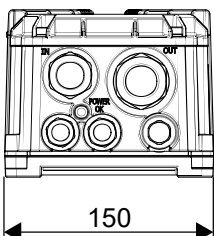

3

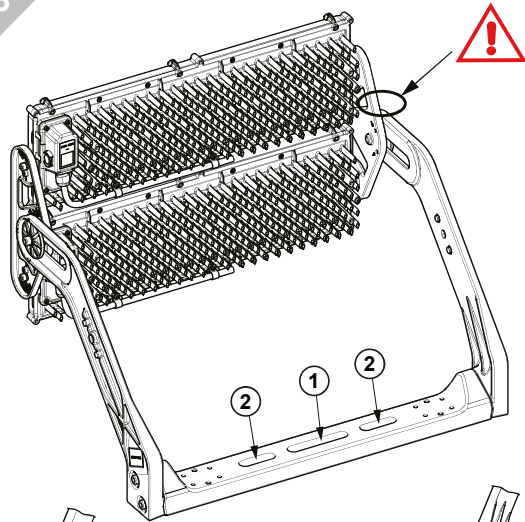

For installation higher >3m  
 Secure product with retaining cable  
 attached to the frame (not included in the delivery).  
 Please refer to local installation norms/regulations.

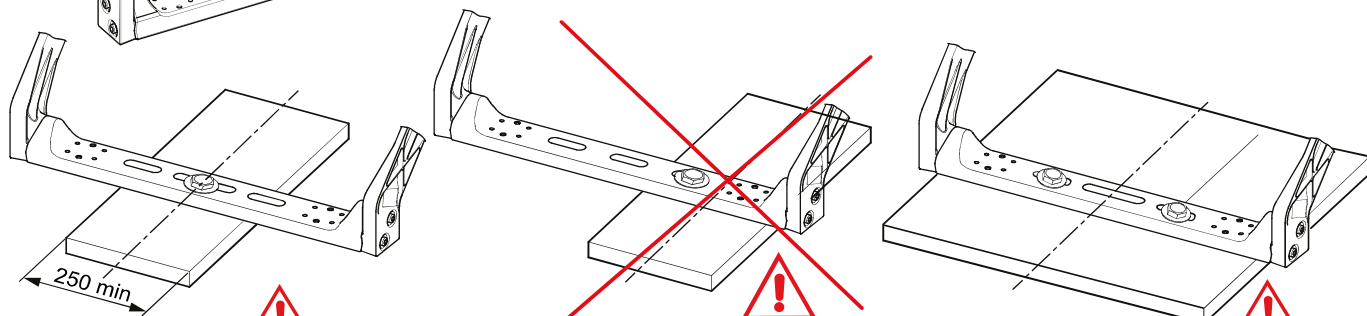
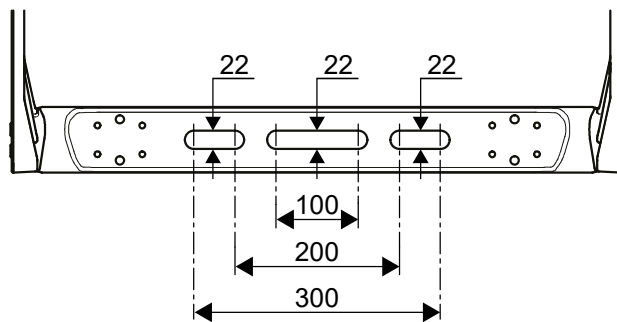

① 1xM20 with extra large washer (not provided)

② 2xM20 with extra large washer (not provided)

4

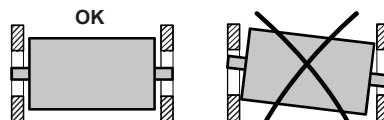
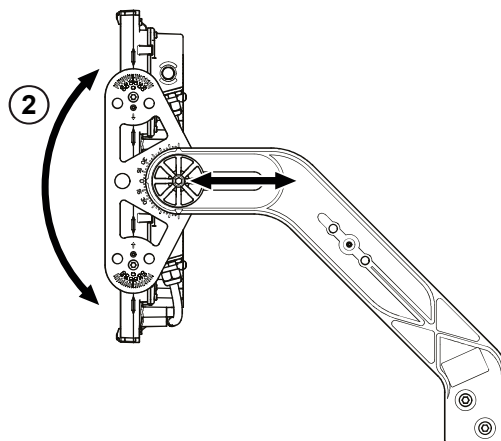
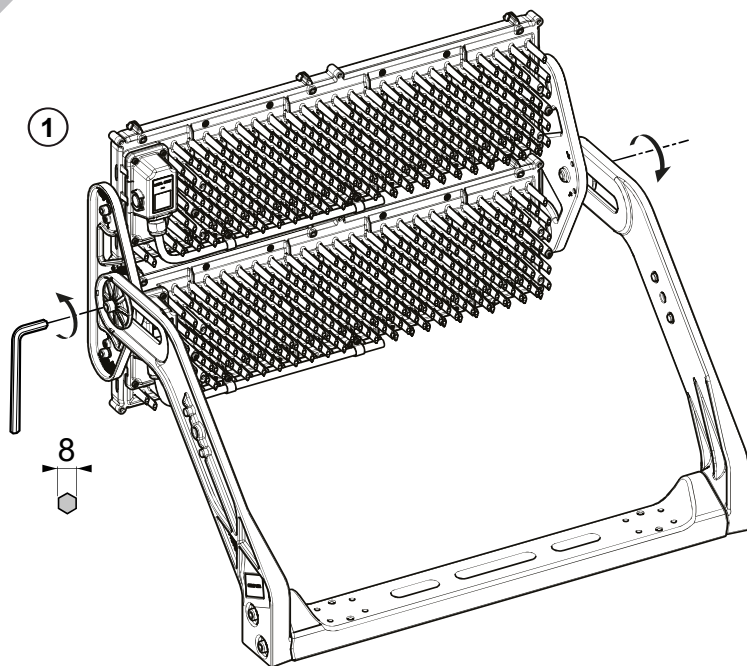

③

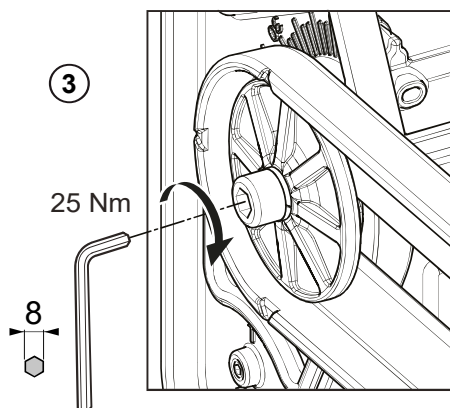

④

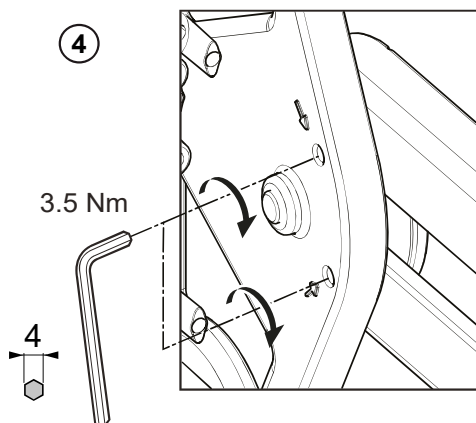

# ALG5 - BW - 264L140 - 740 PST NB MB ANT

TOP BRICK MID BRICK

Symmetrical / Elliptical beam  
(NB, MB, WB, EB)

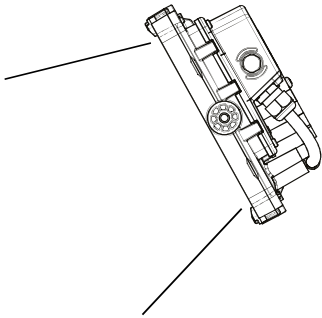

Asymmetrical beam  
(A4, A5, A6, AI5, AI6, EW2)

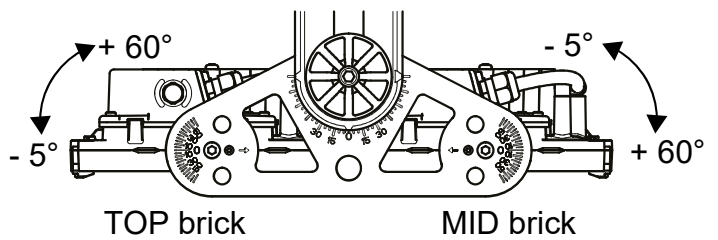
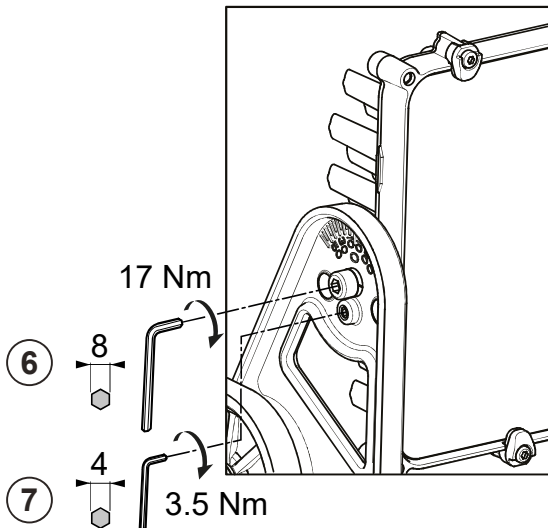
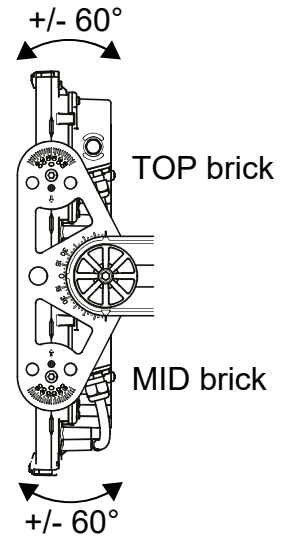
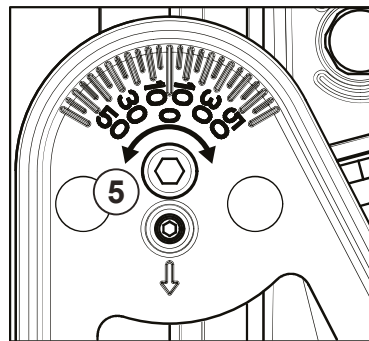
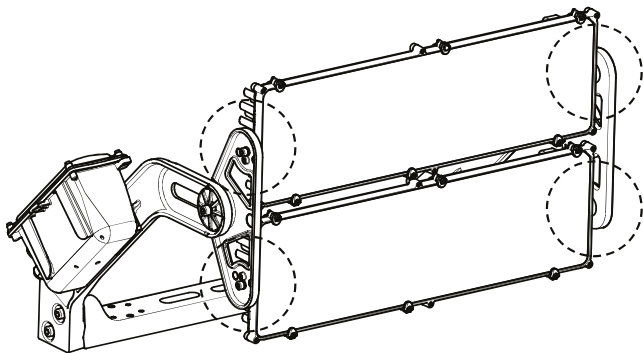
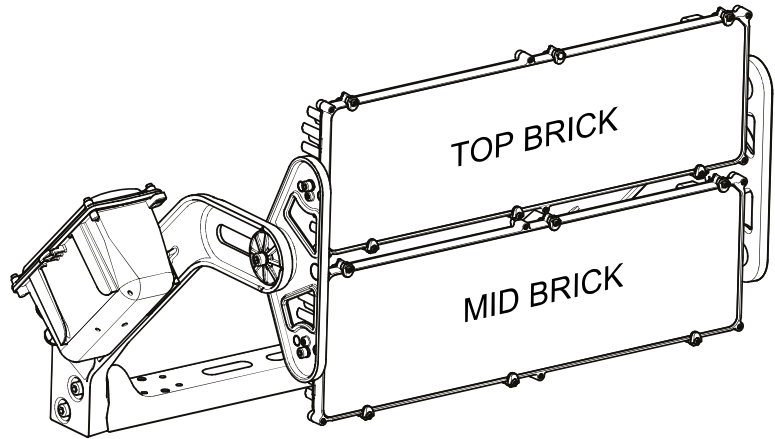
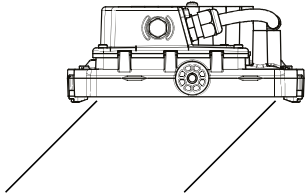

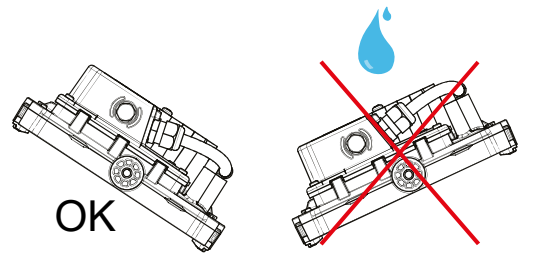
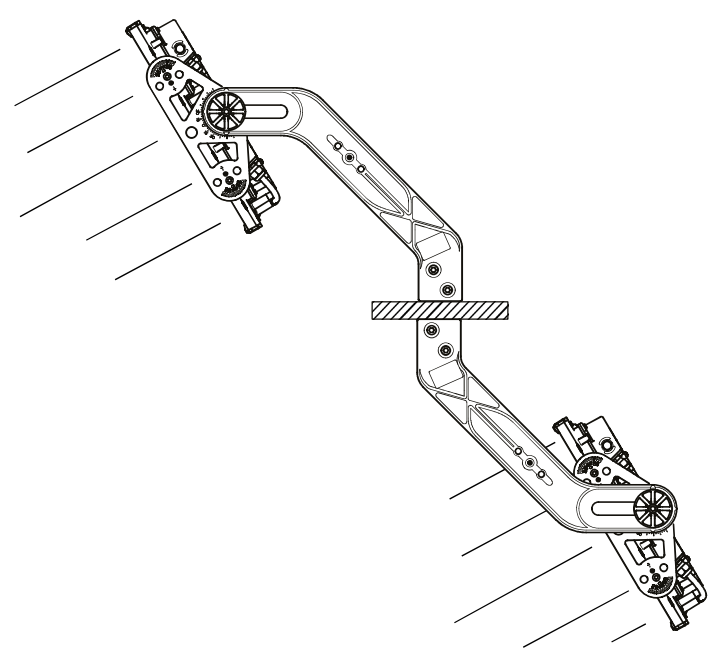
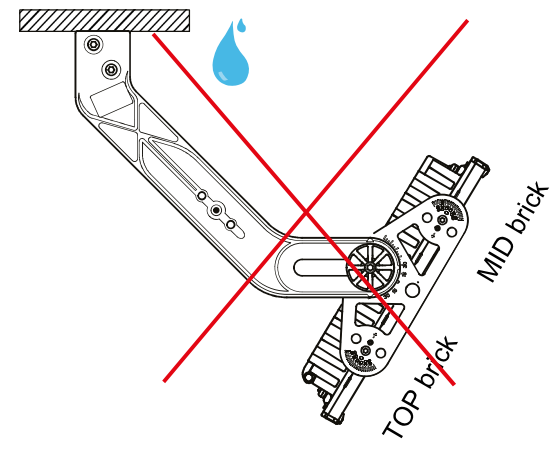
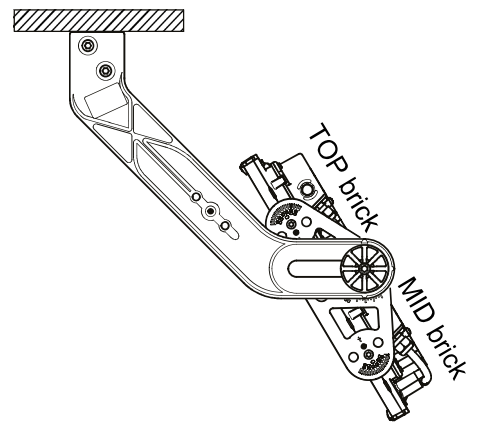
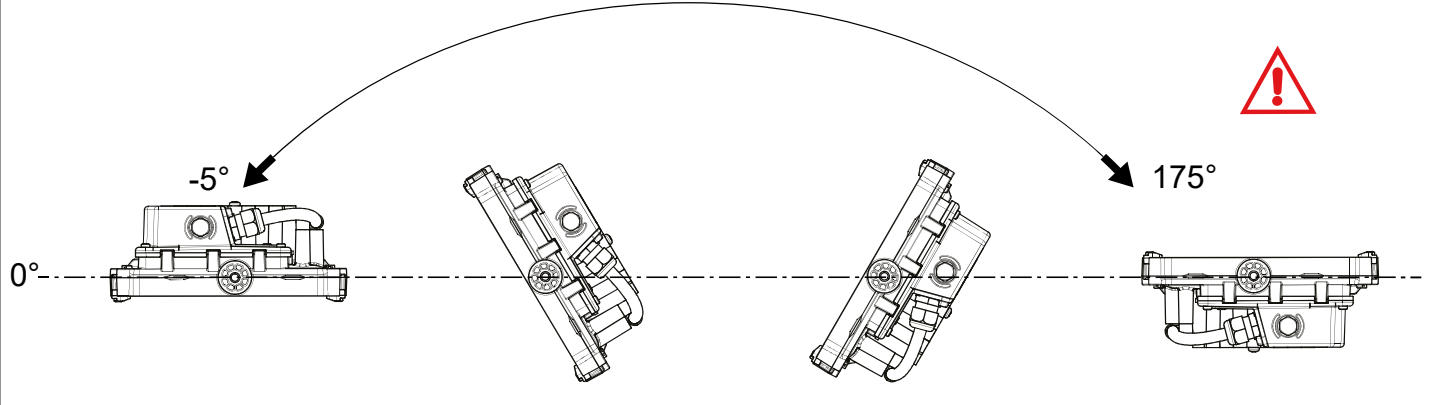
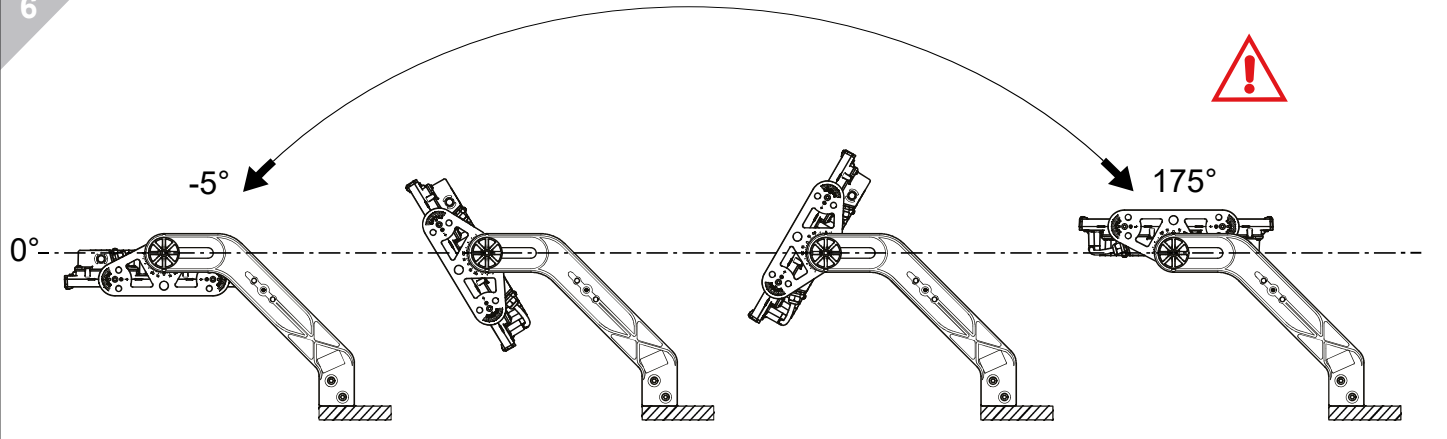

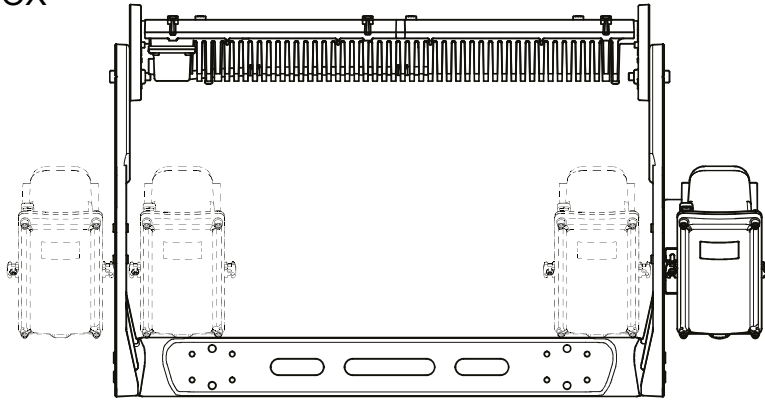

 Choose the right position for the connection box

Version G4/G5

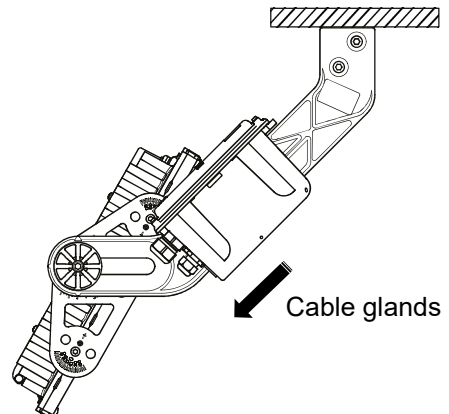
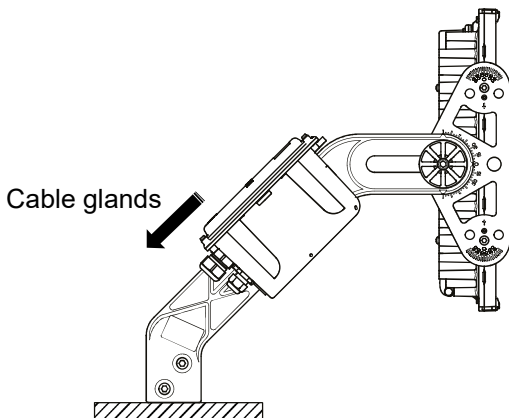
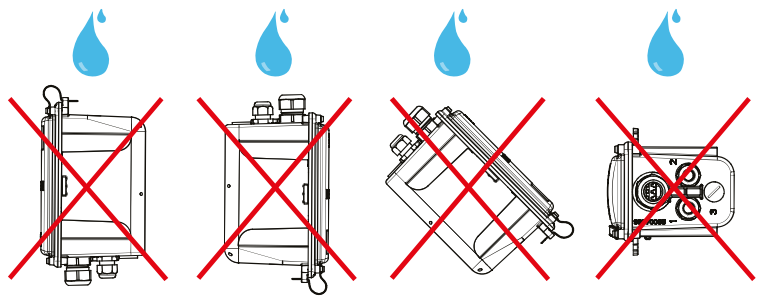
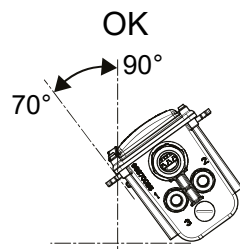
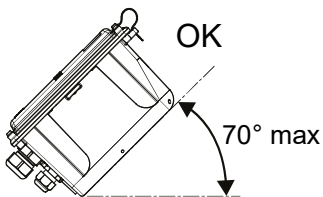
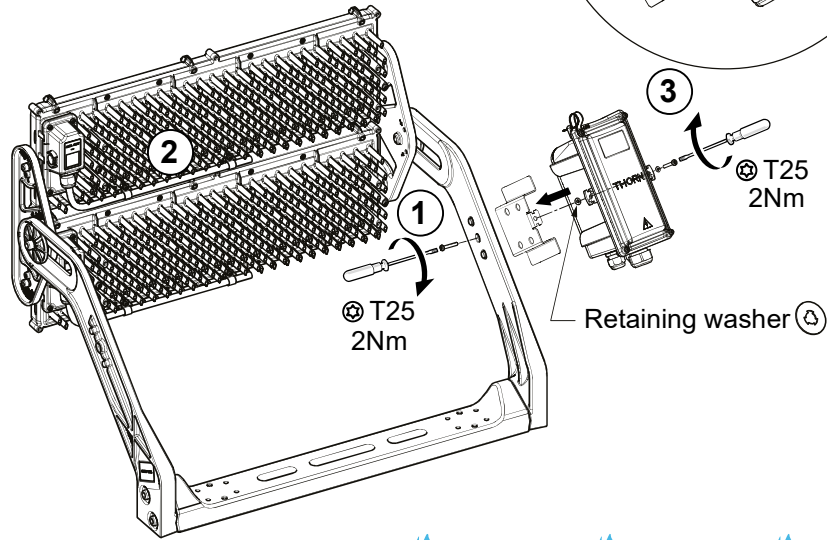
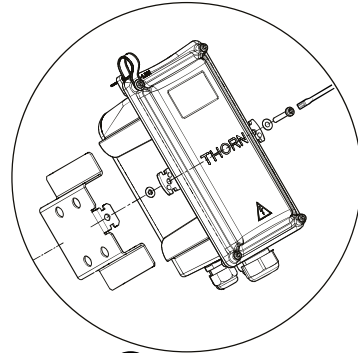
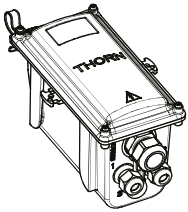

ELECTRICAL CONNECTION

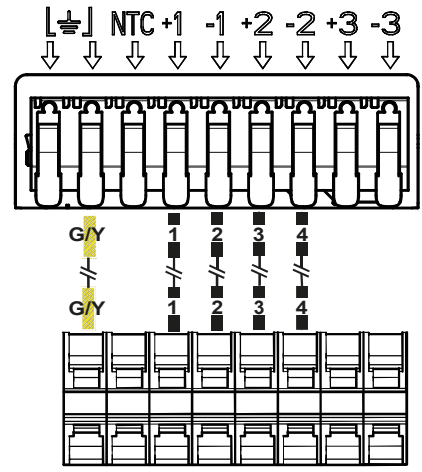
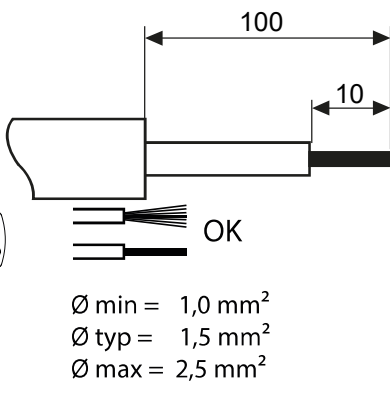
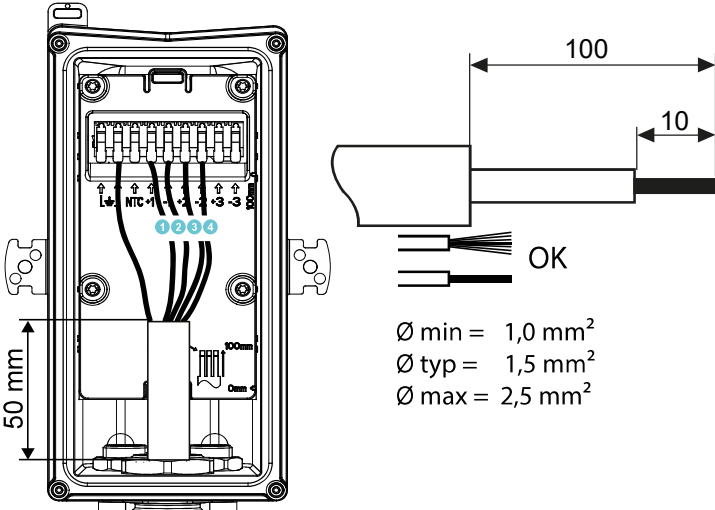
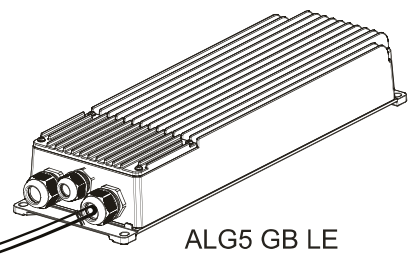
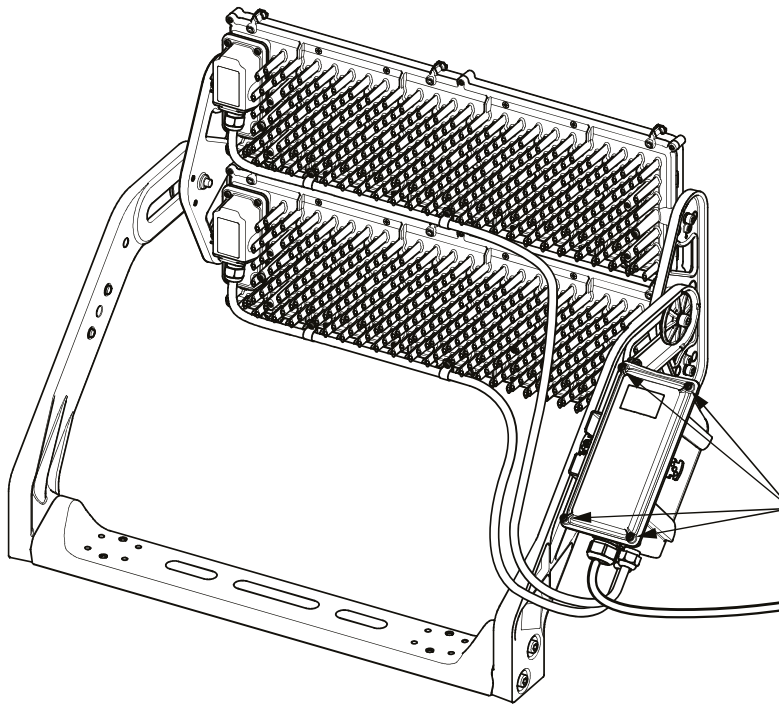
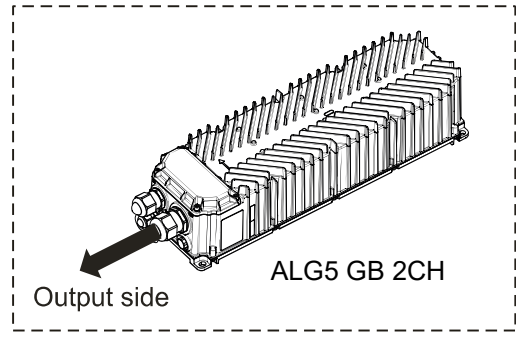

H 36  
5 Nm

CABLE GLAND		
TYPE	ØMin	ØMax
M32	13 mm	21 mm

PINOUT		
Number	Label	Description
1	+1	LED CW + Connection
2	-1	LED CW - Connection
3	+2	LED WW + Connection
4	-2	LED WW - Connection
	+3	NO CONNECT
	-3	NO CONNECT
	NTC	Thermal Measure INPUT
	GND	PROTECTIVE EARTH
	GND	PROTECTIVE EARTH

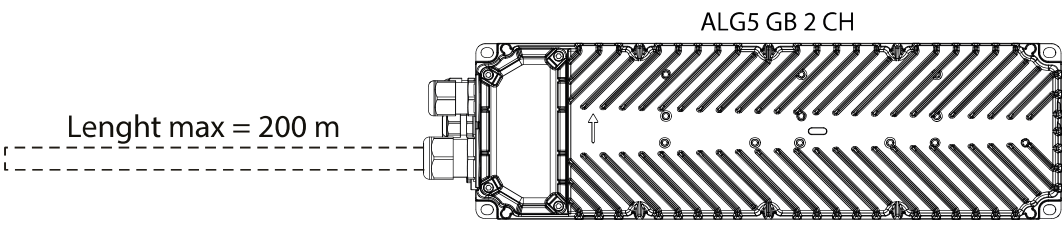
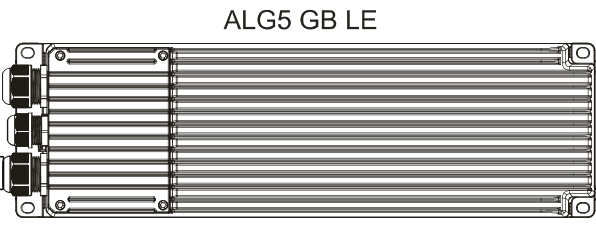
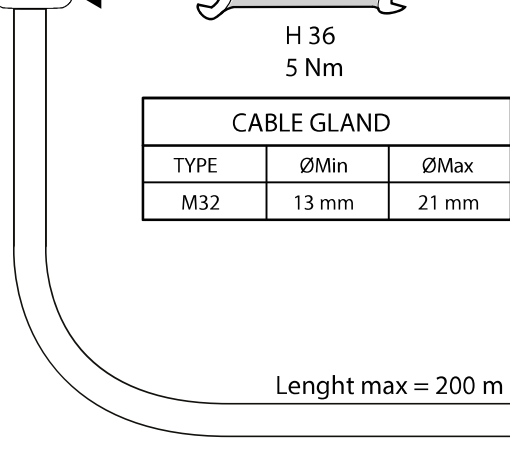

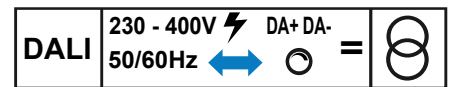
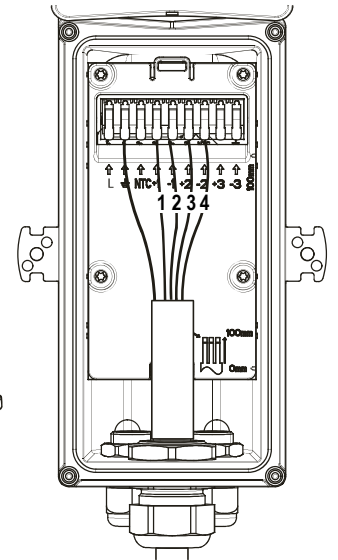
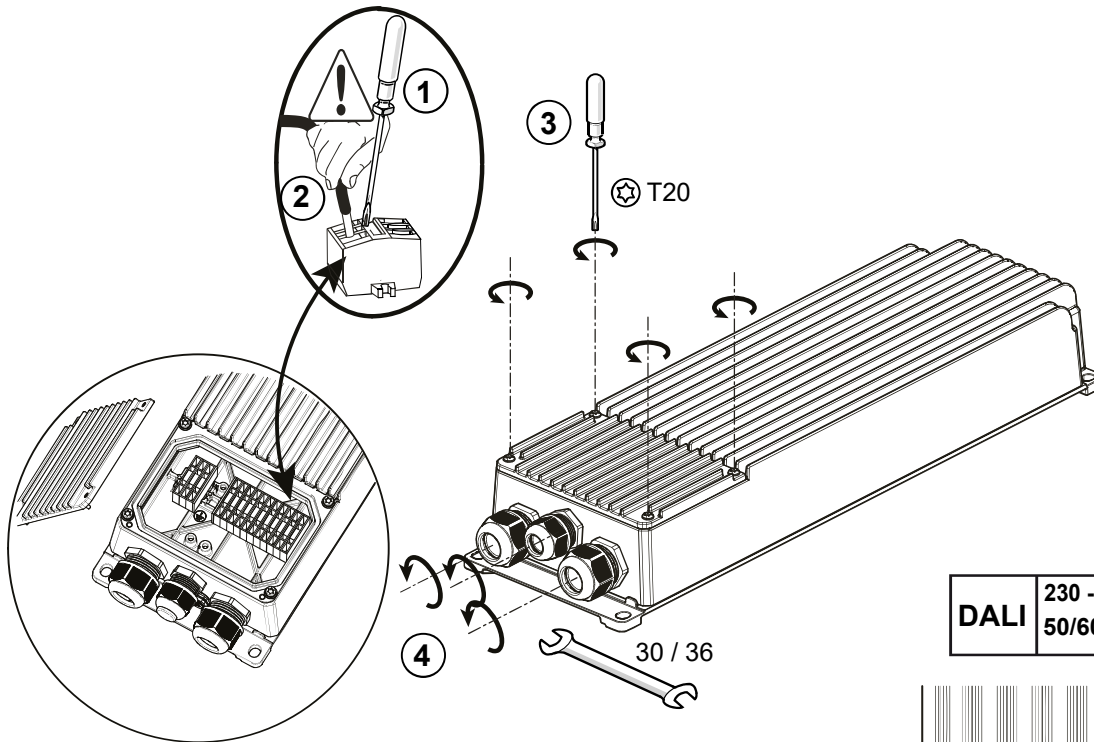
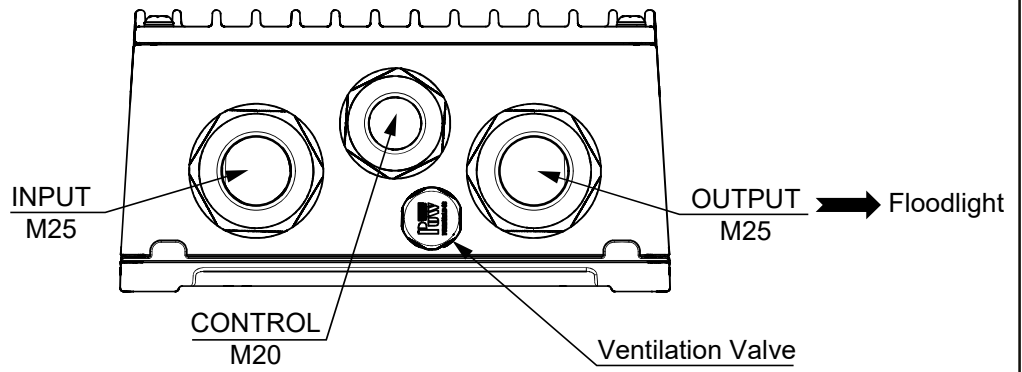
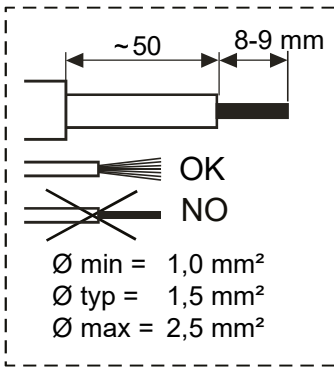

**Extreme caution :** Do not connect any LED CONNECTION wire (high voltage) inside NTC connector !! It could result in a critical failure and damage irreversibly the CHAMPION luminaire

PINOUT		
Number	Label	Description
1	L1	AC INPUT
2	L2 / N	AC INPUT L2 second Line or Neutral
3	PE	PROTECTIVE EARTH
4	PE	PE FOR LED MODULE
5	+24V	Do not connect
6	DA-	DALI input -
7	DA+	DALI input +
8	NTC	Do not connect
9	V2+	LED WW + CONNECTION
10	V2-	LED WW - CONNECTION
11	V1+	LED CW + CONNECTION
12	V1-	LED CW - CONNECTION

Do not connect

Do not connect

Recommended :  
H07RNF 3G1.5 mm<sup>2</sup>  
or 3G2,5 mm<sup>2</sup>

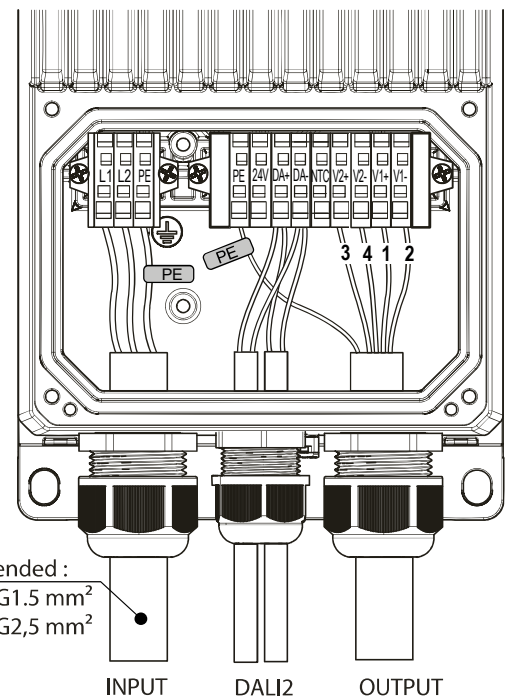

INPUT

DALI2

OUTPUT



The wiring should follow marking instruction, Otherwise the product could be damaged or the fonctions could be affected. Each set of + or - are not potential identical, cross connection is prohibited.

**CABLE GLAND**

TYPE	ØMin	ØMax
M20	5 mm	6.5 mm
M25	10 mm	16.3 mm



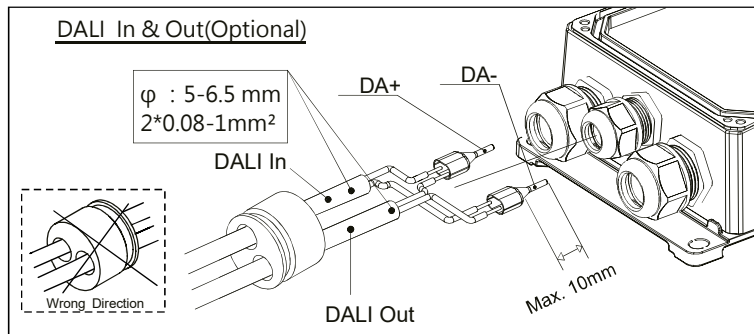
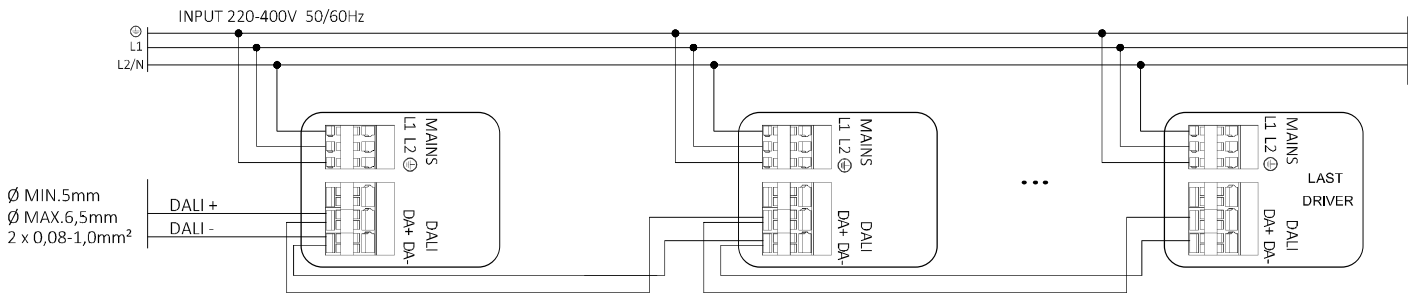
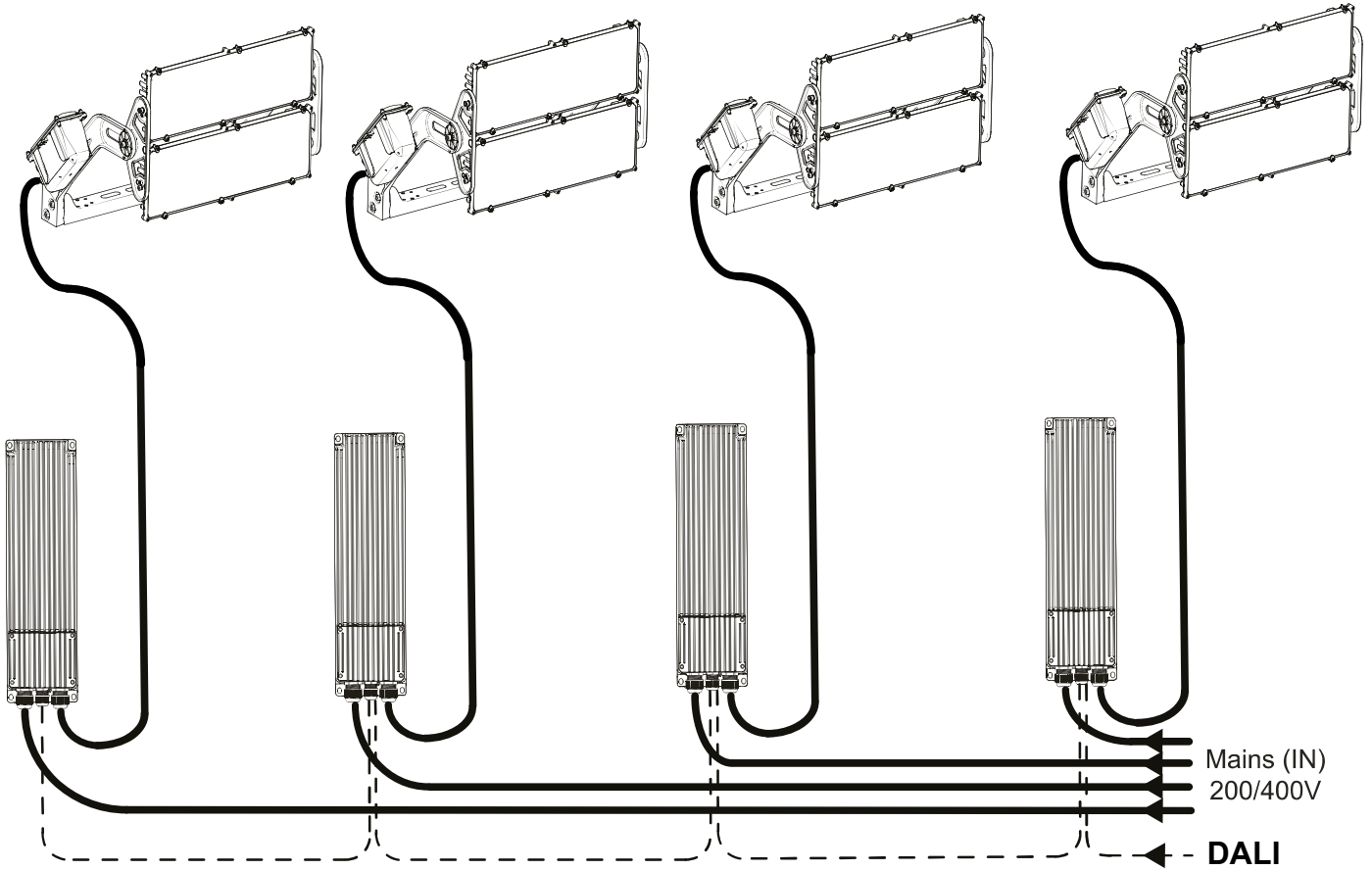

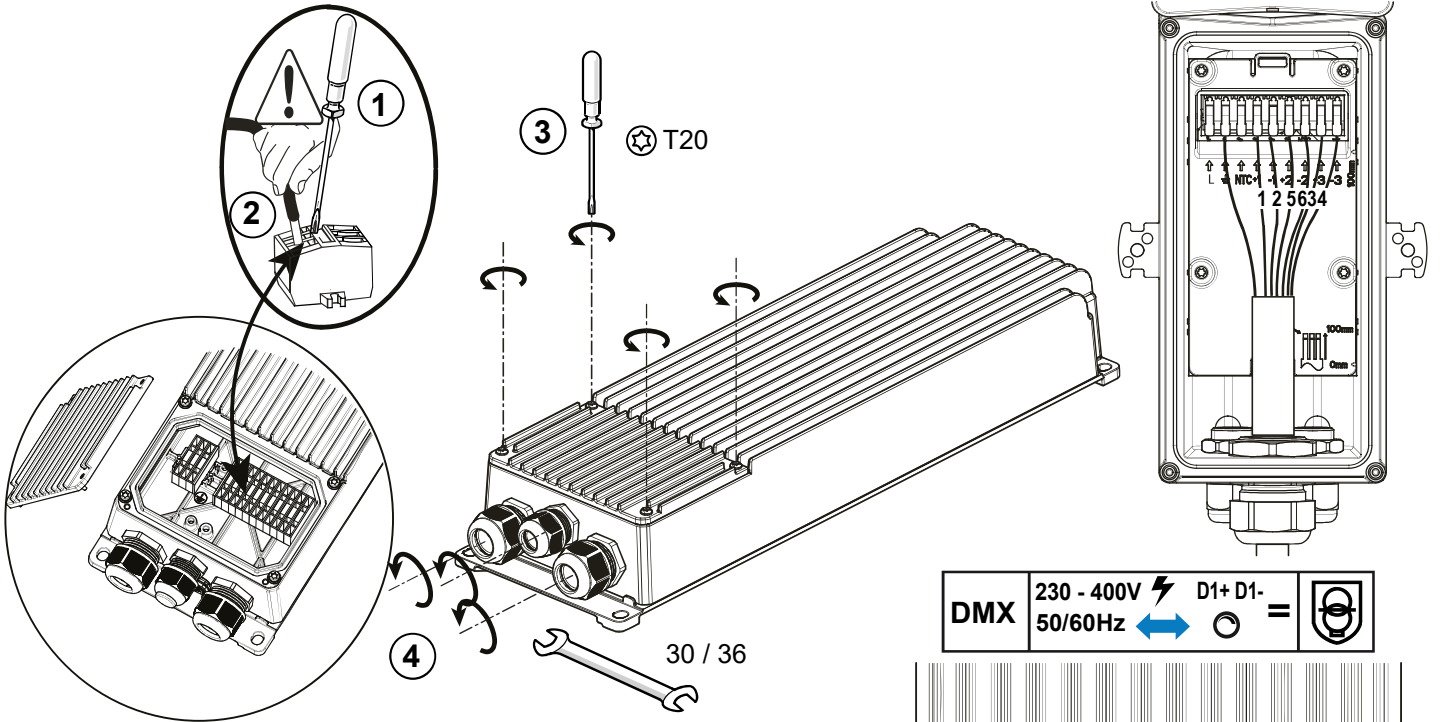
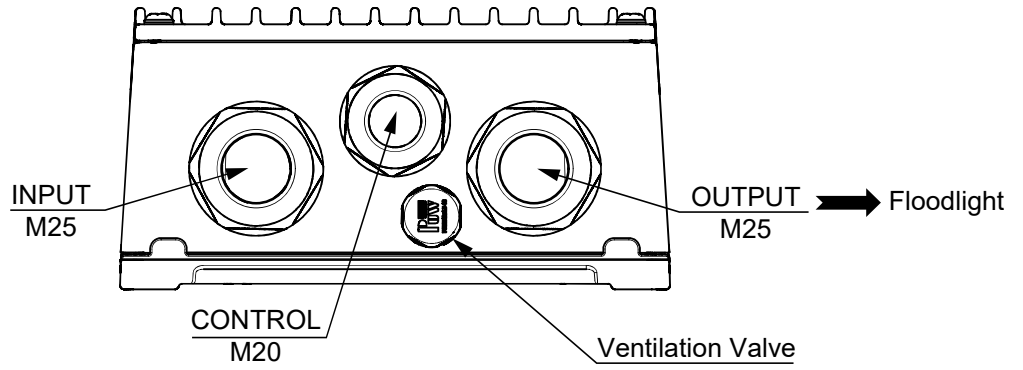
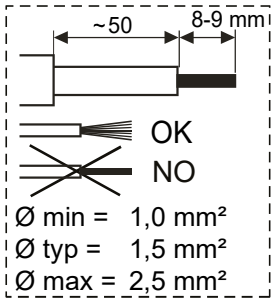

**Extreme caution :** Do not connect any LED CONNECTION wire (high voltage) inside NTC connector !! It could result in a critical failure and damage irreversibly the CHAMPION luminaire

PINOUT		
Number	Label	Description
1	L1	AC INPUT
2	L2 / N	AC INPUT L2 second Line or Neutral
3	PE	PROTECTIVE EARTH
4	PE	PE FOR LED MODULE
5	COM	RDM-DMX Common port/Shield
6	D1-	RDM-DMX input -
7	D1+	RDM-DMX input +
8	NTC	Do not connect
9	V2+	LED WW + CONNECTION
10	V2-	LED WW - CONNECTION
11	V1+	LED CW + CONNECTION
12	V1-	LED CW - CONNECTION

Recommended :  
H07RNF 3G1.5 mm<sup>2</sup>  
or 3G2,5 mm<sup>2</sup>

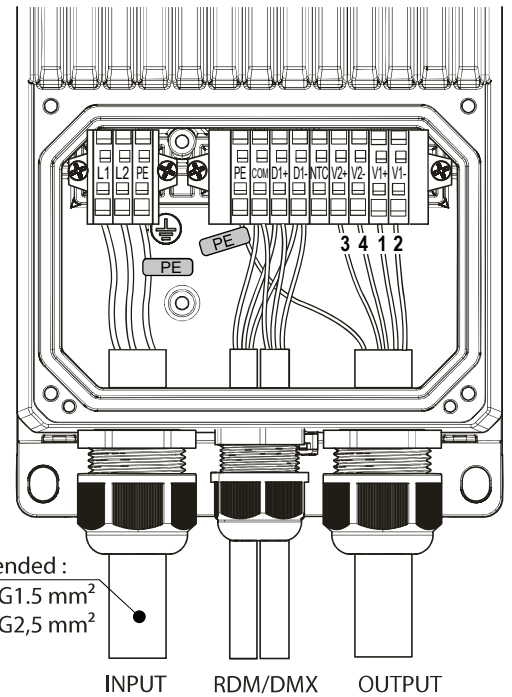

**!** The wiring should follow label marking instruction, Otherwise the product could be damaged or the fonctions could be affected. Each set of + or - are not potential identical, cross connection is prohibited.

CABLE GLAND		
TYPE	ØMin	ØMax
M20	5 mm	6.5 mm
M25	10 mm	16.3 mm

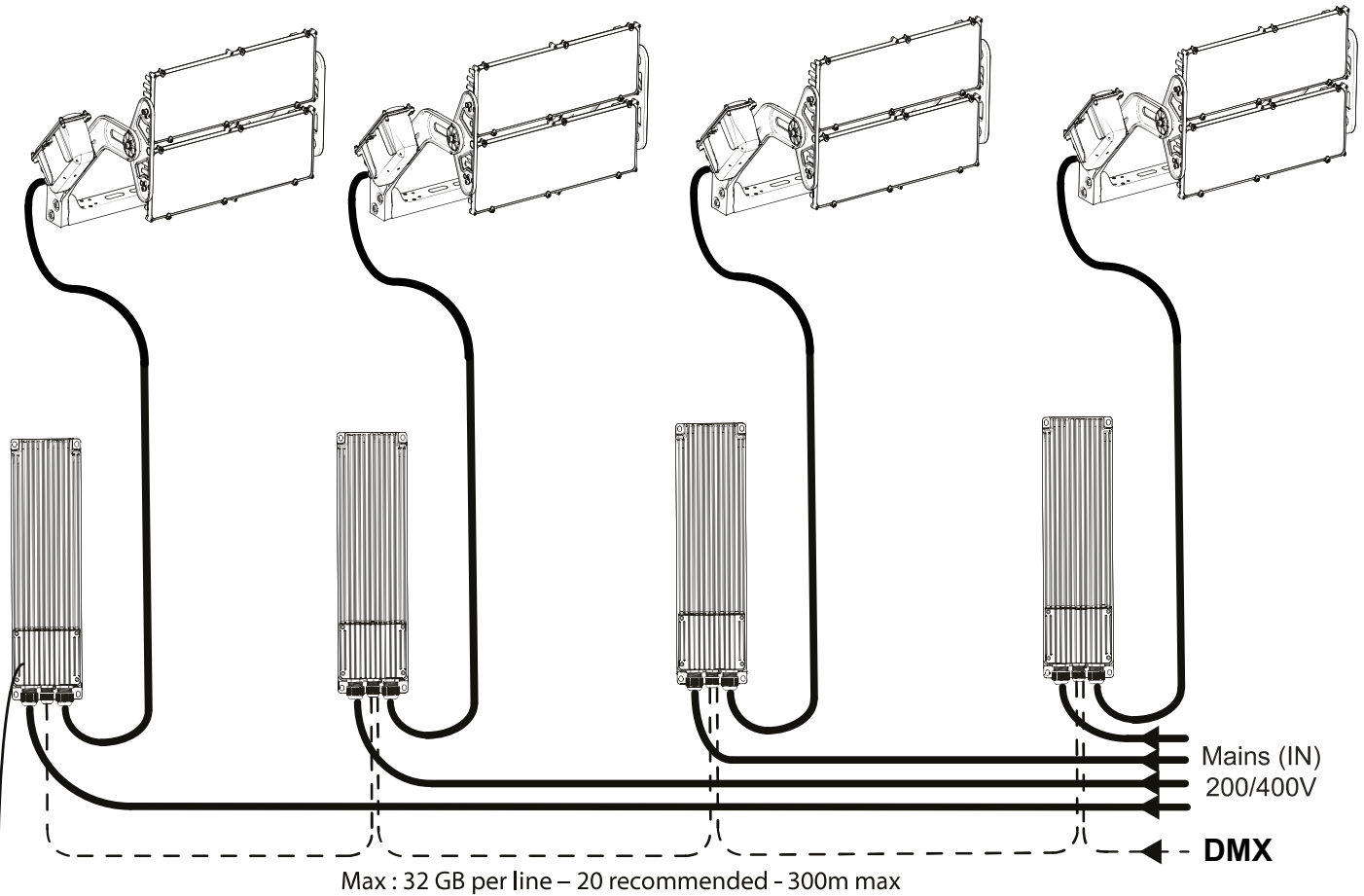

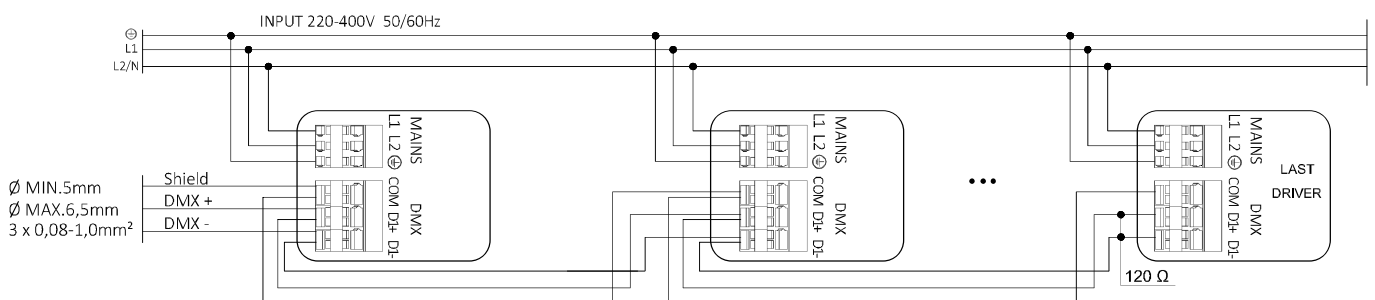
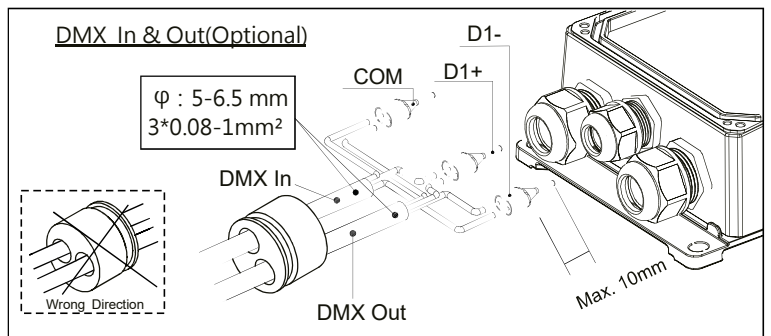
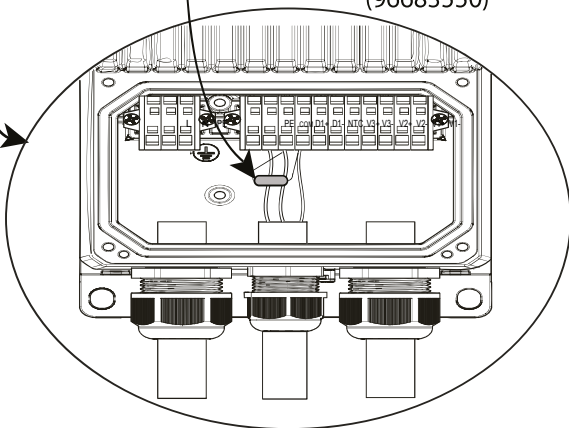

« DMX-RDM wiring shall respect ANSI E1.11 and AINSI E1.20 installation rules».  
 DMX is a three-wire system, use all three! DMX is based on RS-485 standard.  
 Always use cable designed for DMX / RS-485 installations

Last device on the line shall be properly terminated with a 120Ω 0.5W 5% resistance (96683550)

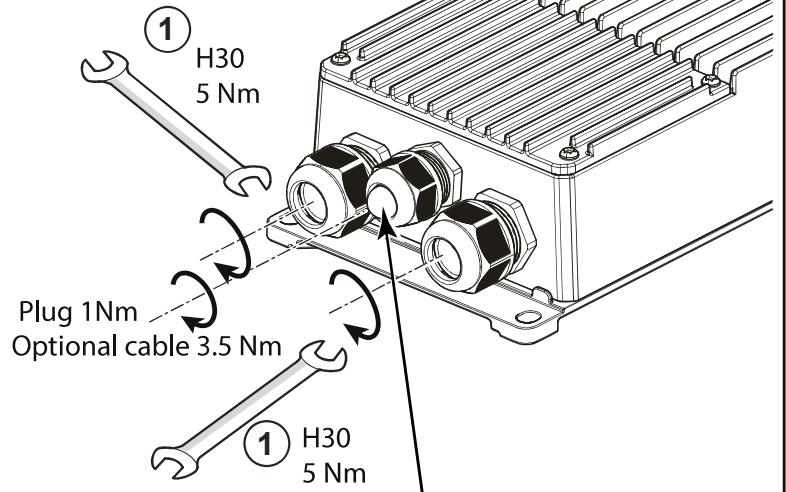
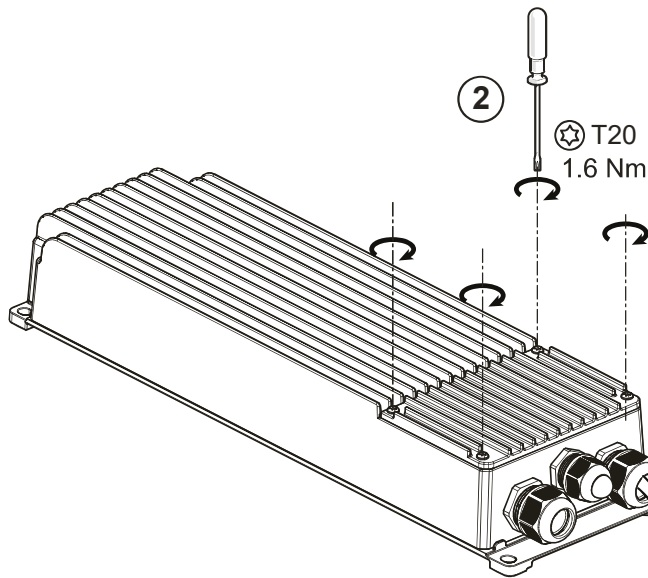

ALTIS G5 GB LE MOUNTING



 In case of non-dimming control application, the dimming (DALI or RDM/DMX) gland is still required for water-proof.

Drilling recommendation:

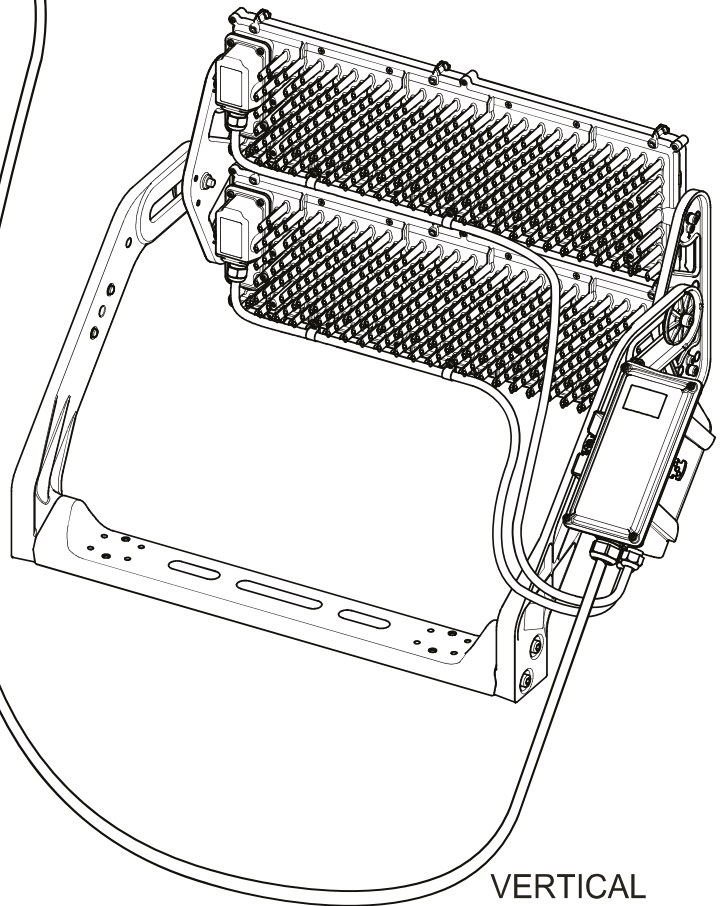
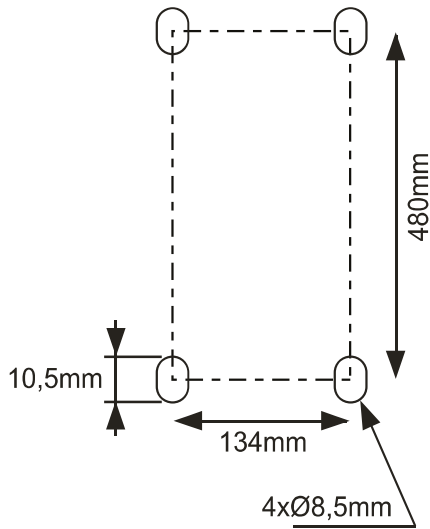

HORIZONTAL

LATERAL / SIDE

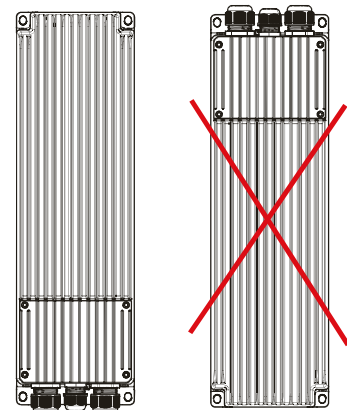
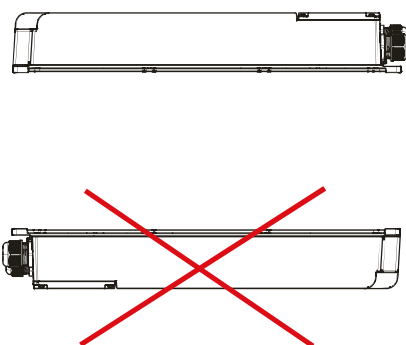

GUIDELINE FOR INTEGRATION OF GEAR BOX

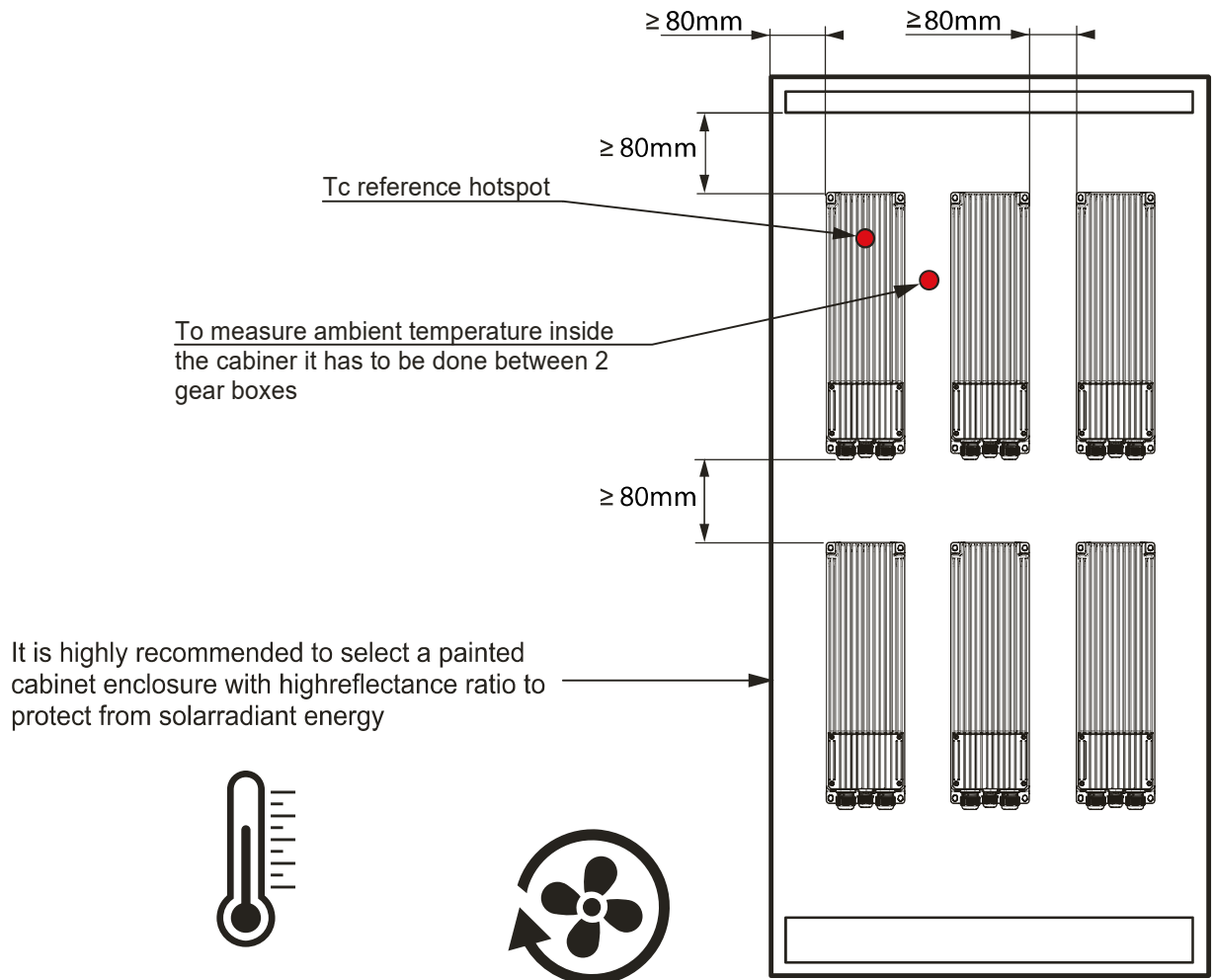

If you cannot follow instructions included in previous section regarding gear box integration, you have to measure Tc reference point taking into consideration that measures must be down to Tc\_max

Tc Reference at Max Ambient			
Position	Horizontal	Vertical	Side
Mounting			
230Vac	85°C	84°C	85°C (Ref.)
400Vac	80°C	77°C	80°C (Ref.)
Ambient Max	50°C	50°C	50°C (Ref.)

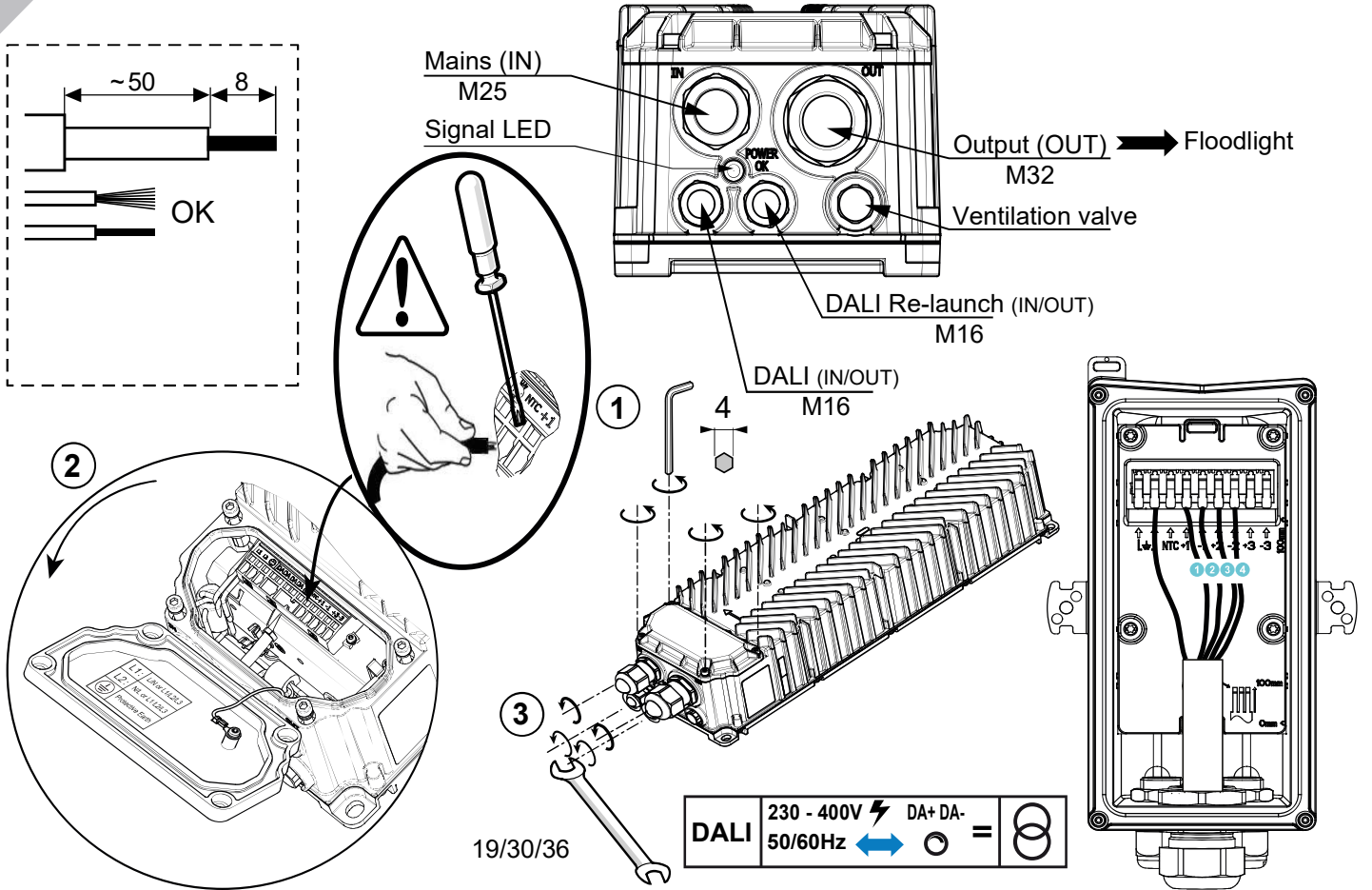

**Extreme caution :** Do not connect any LED CONNECTION wire (high voltage) inside NTC connector !! It could result in a critical failure and damage irreversibly the ALTIS luminaire

PINOUT		
Number	Label	Description
	L1	AC LINE 1 INPUT
	L2	AC LINE 2 INPUT
	⊕	PROTECTIVE EARTH
	DA+	DALI INPUT
	DA+	DALI RE-LAUNCH
	DA-	DALI INPUT
	DA-	DALI RE-LAUNCH
	⊕	PROTECTIVE EARTH FOR LUMINAIRE
	NTC	THERMAL MEASURE INPUT
1	+1	LED CW + CONNECTION
2	-1	LED CW - CONNECTION
3	+3	LED WW + CONNECTION
4	-3	LED WW - CONNECTION

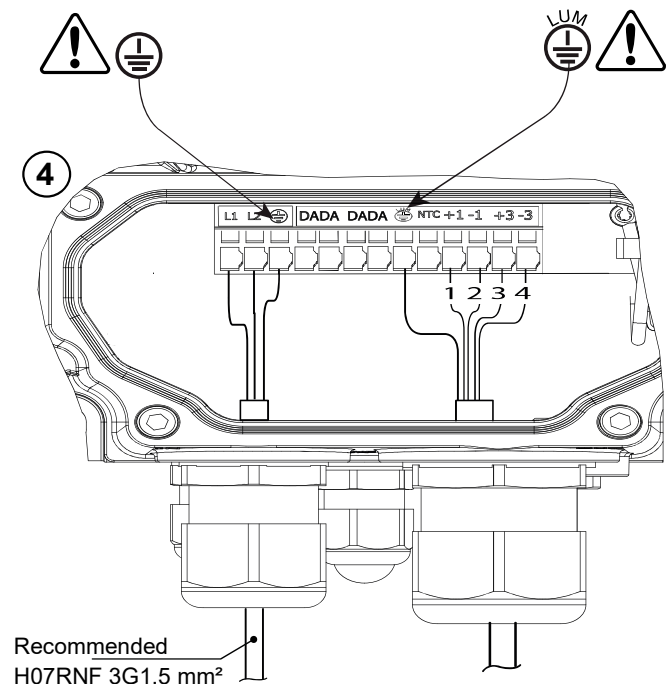

SIGNALLING LED INDICATIONS ON THE GEAR BOX			
PERIOD	PULSES	FAULT DESCRIPTION	PRIORITY
The encoded faults are based on pulses emitted every 4 seconds	1	One or more active outputs is not working	Maximum ↑ Minimum
	5	Undervoltage on one or more active outputs	
	2	short circuit on one or more active outputs	
	3	One or more active outputs disconnection from load	
	4	Overload on one or more active outputs	

CABLE GLAND		
TYPE	ØMin	ØMax
M16	5 mm	10 mm
M25	10 mm	17 mm
M32	13 mm	21 mm

SEAL REDUCER for GB and FLOOD		
TYPE	ØMin	ØMax
M32	10 mm	16 mm

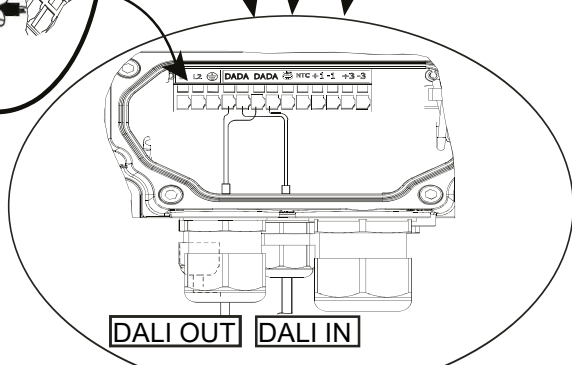
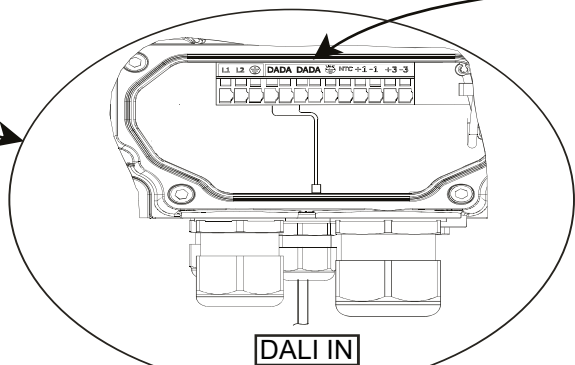
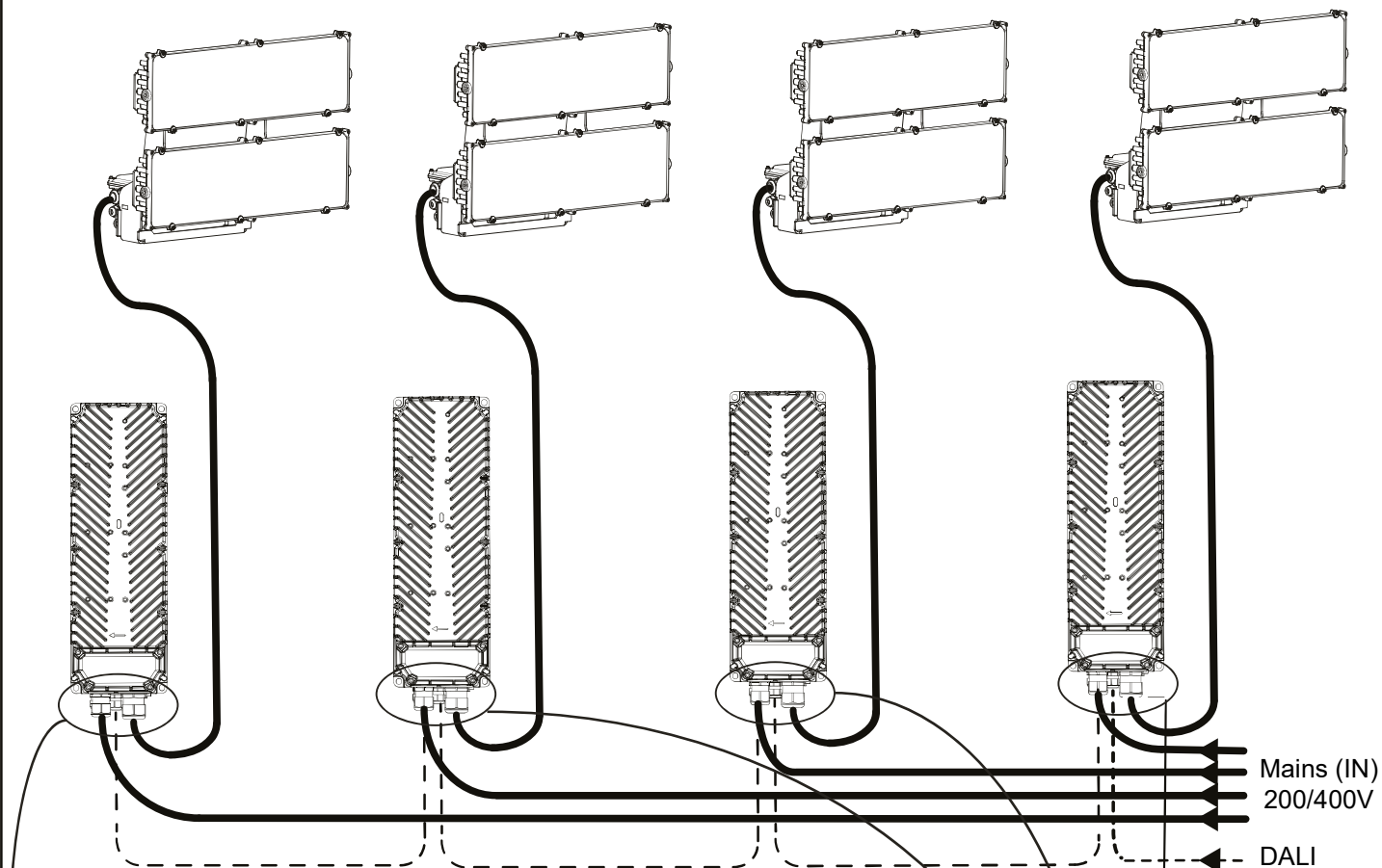
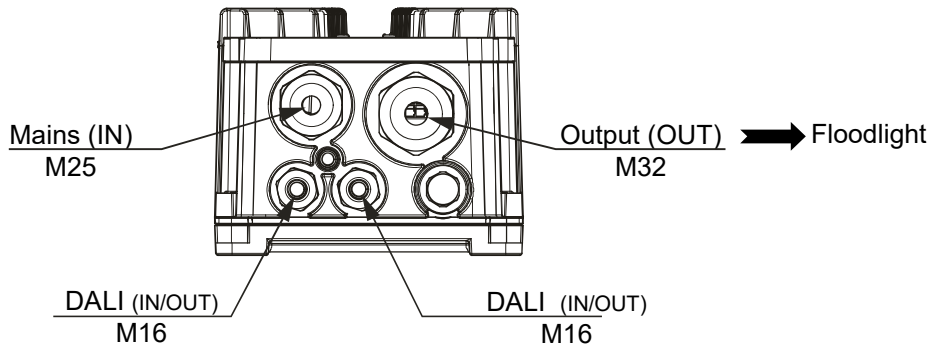

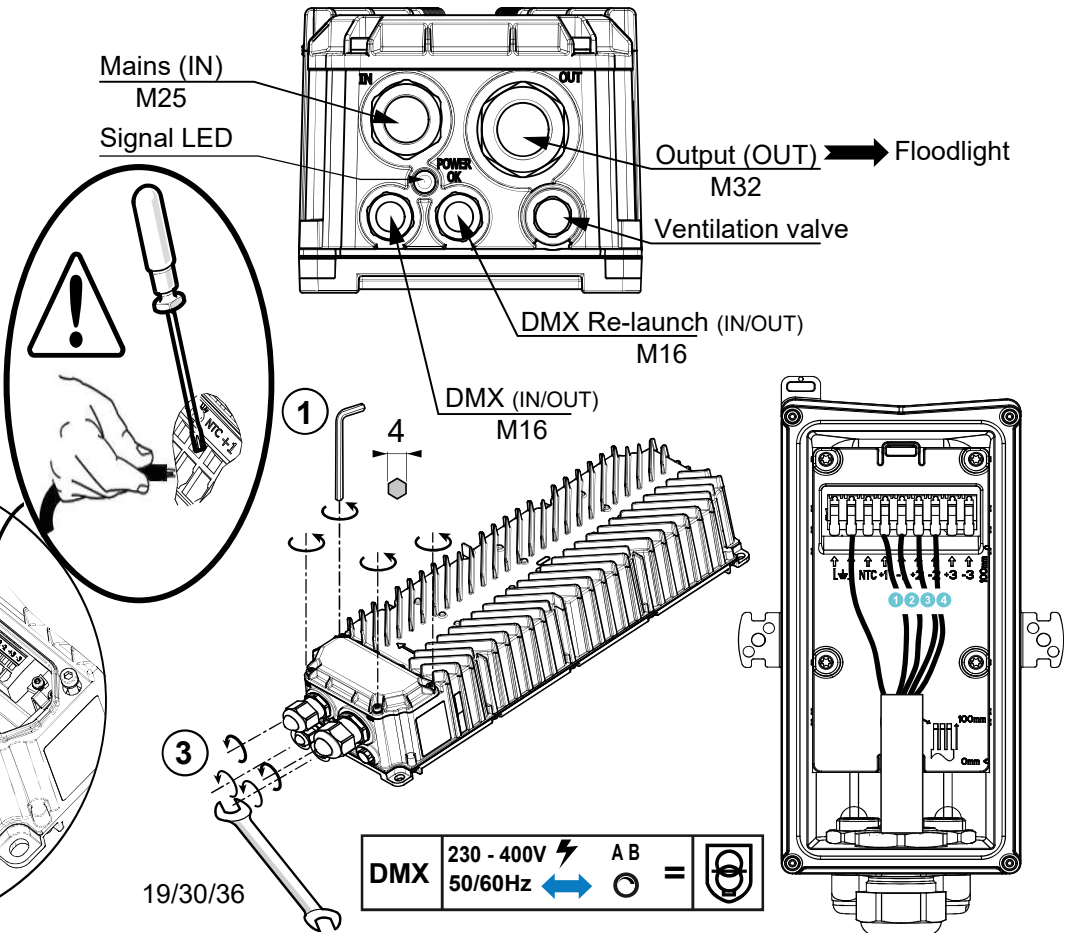
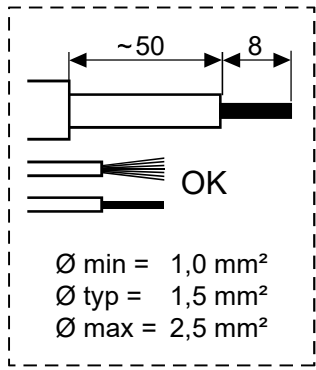

**Extreme caution** : Do not connect any LED CONNECTION wire (high voltage) inside NTC connector !! It could result in a critical failure and damage irreversibly the ALTIS luminaire

PINOUT		
Number	Label	Description
	L1	AC LINE 1 INPUT
	L2	AC LINE 2 INPUT
	⊕	PROTECTIVE EARTH
	A	DMX INPUT DATA+
	A	DMX-RE-LAUNCH DATA+
	B	DMX INPUT DATA-
	B	DMX-RE-LAUNCH DATA-
	C	DMX COMMON / SHIELD
	C	DMX COMMON / SHIELD
	⊕	PROTECTIVE EARTH FOR LED MODULE
	NTC	THERMAL MEASURE INPUT
1	+1	LED CW + CONNECTION
2	-1	LED CW - CONNECTION
3	+3	LED WW + CONNECTION
4	-3	LED WW - CONNECTION

SIGNALLING LED INDICATIONS ON THE GEAR BOX			
PERIOD	PULSES	FAULT DESCRIPTION	PRIORITY
The encoded faults are based on pulses emitted every 4 seconds	1	One or more active outputs is not working	Maximum ↑ Minimum
	5	Undervoltage on one or more active outputs	
	2	short circuit on one or more active outputs	
	3	One or more active outputs disconnection from load	
	4	Overload on one or more active outputs	

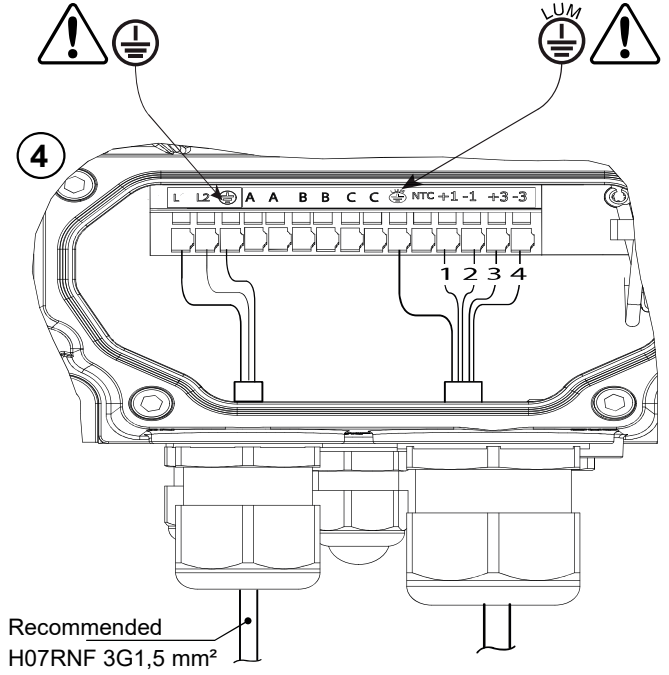

CABLE GLAND		
TYPE	ØMin	ØMax
M16	5 mm	10 mm
M25	10 mm	17 mm
M32	13 mm	21 mm

SEAL REDUCER for GB and FLOOD		
TYPE	ØMin	ØMax
M32	10 mm	16 mm



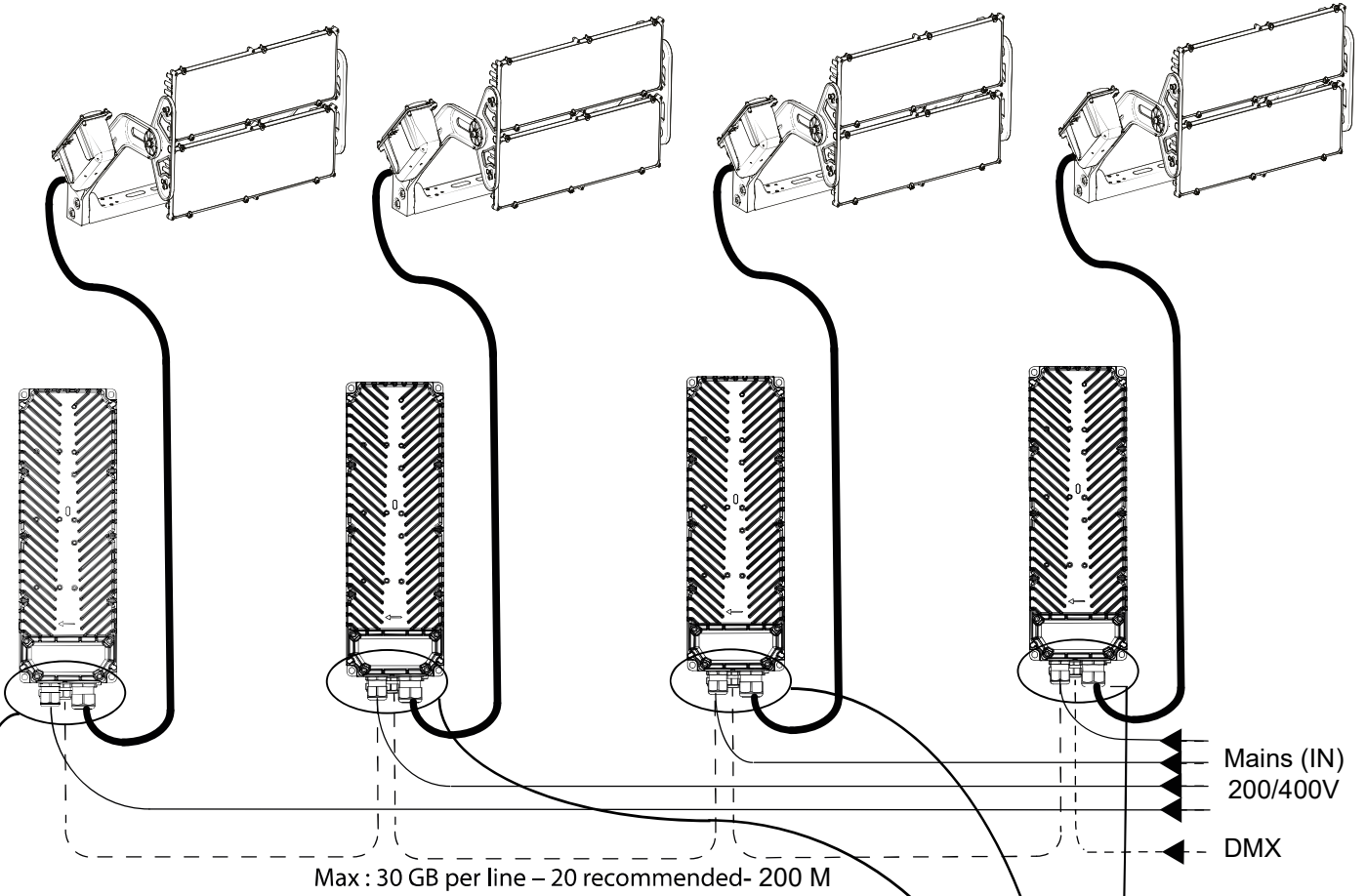
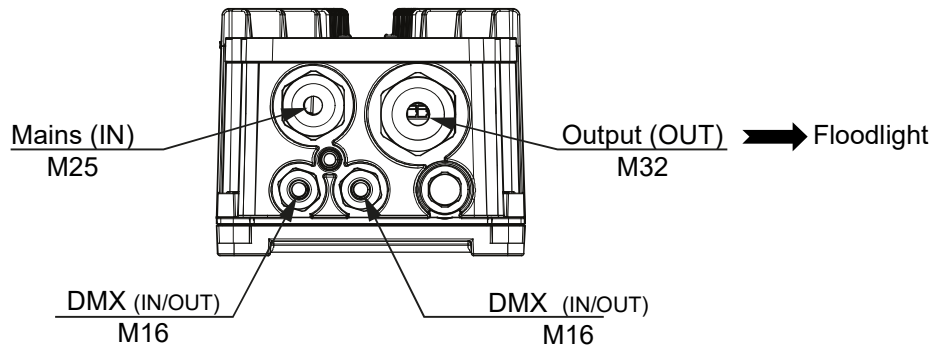

« DMX-RDM wiring shall respect ANSI E1.11 and AINSI E1.20 installation rules».

1 to 3 DMX addresses per GB – changeable via RDM

Last device on the line shall be properly terminated with a 120R 0.5W 5% resistance (96683550)

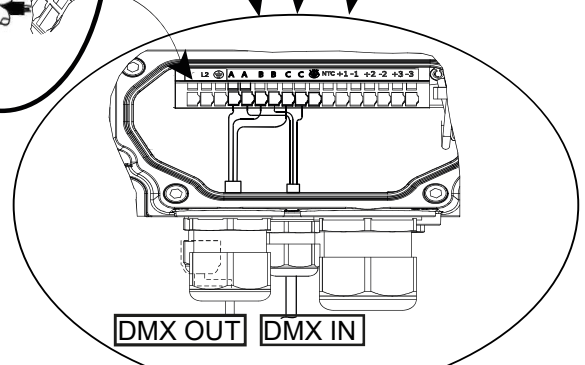
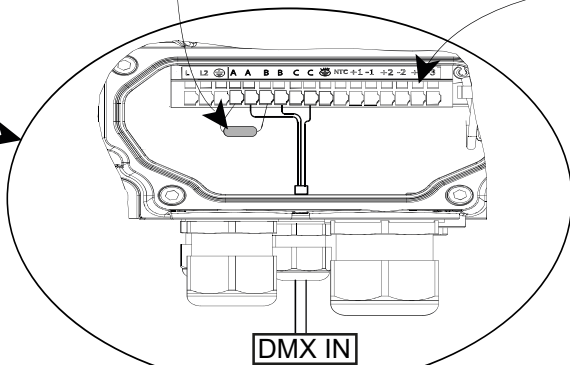

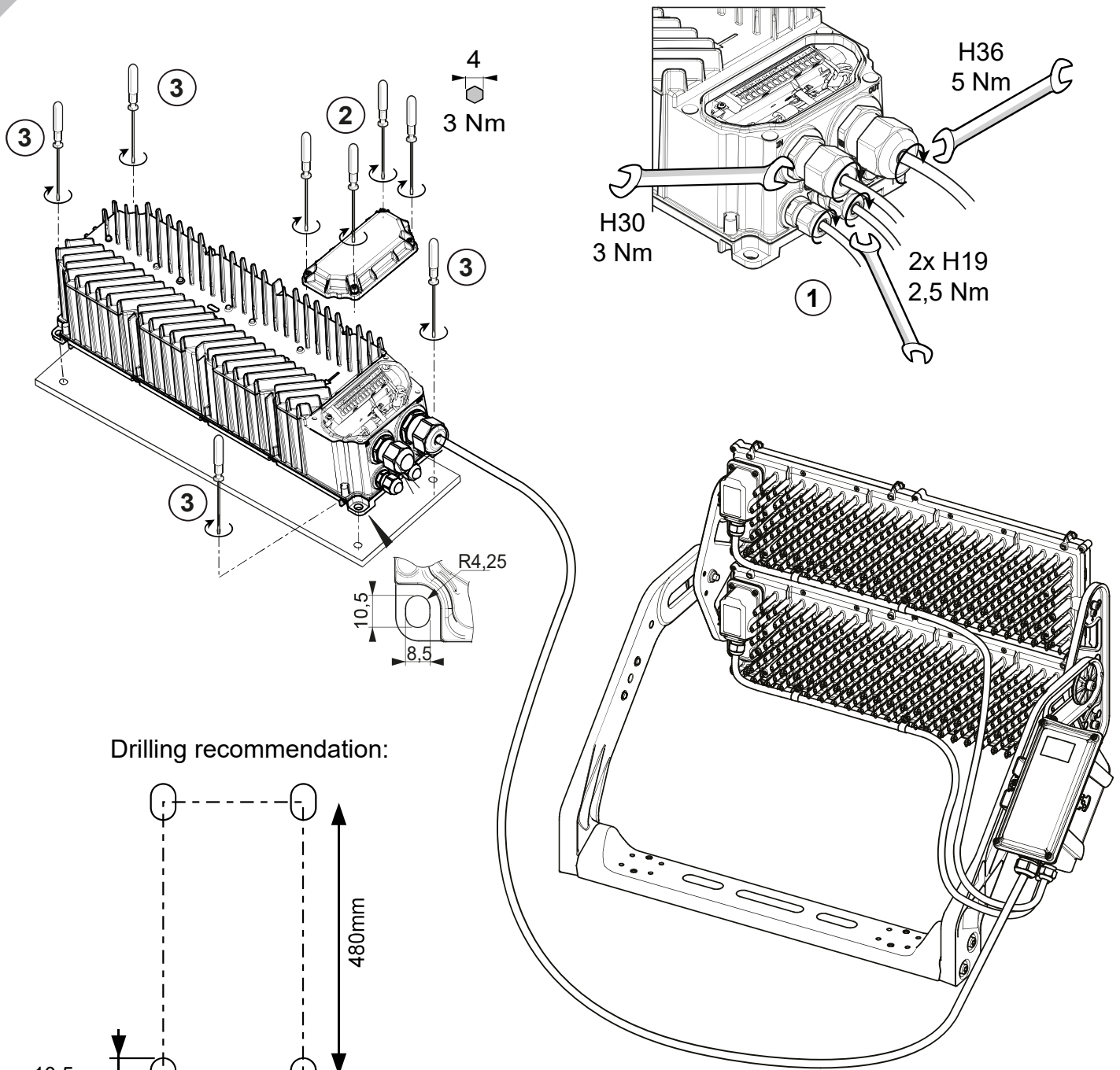

Drilling recommendation:

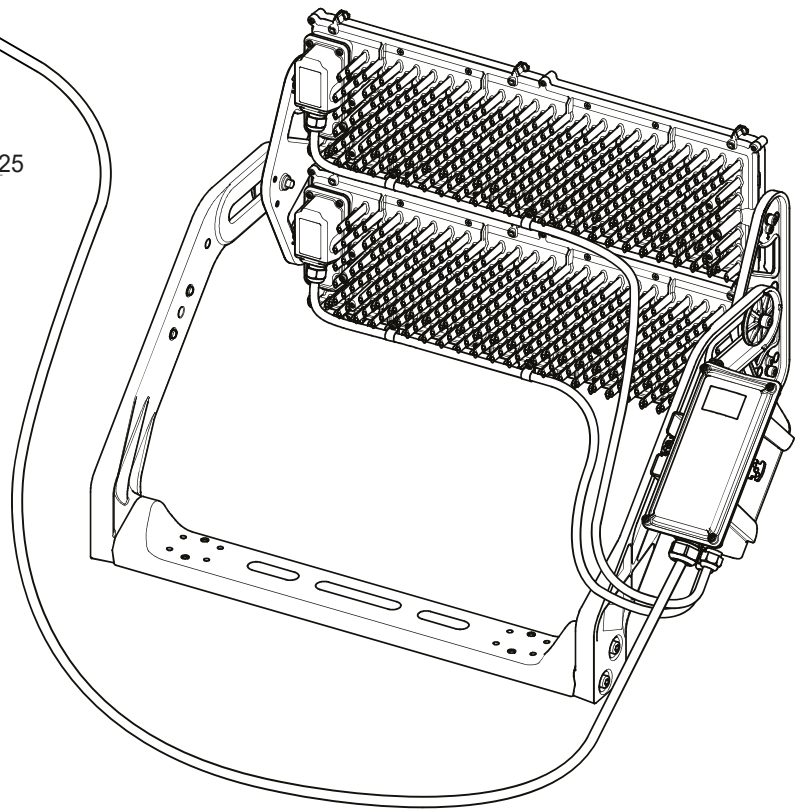
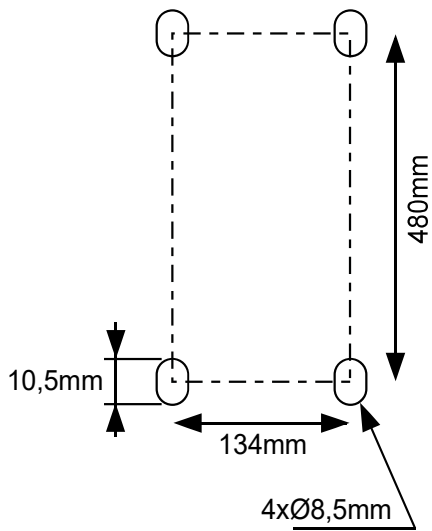

HORIZONTAL

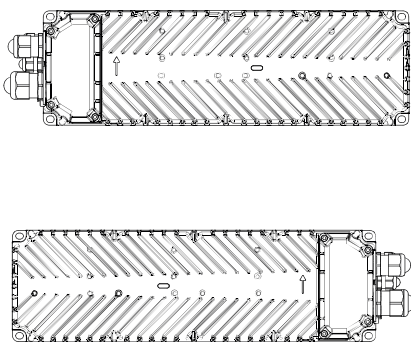

LATERAL / SIDE

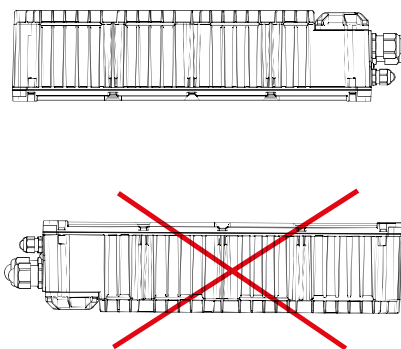

VERTICAL

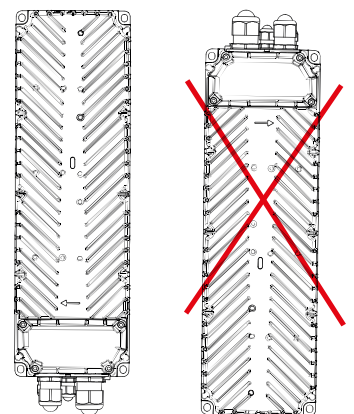

GUIDELINE FOR INTEGRATION OF GEAR BOX

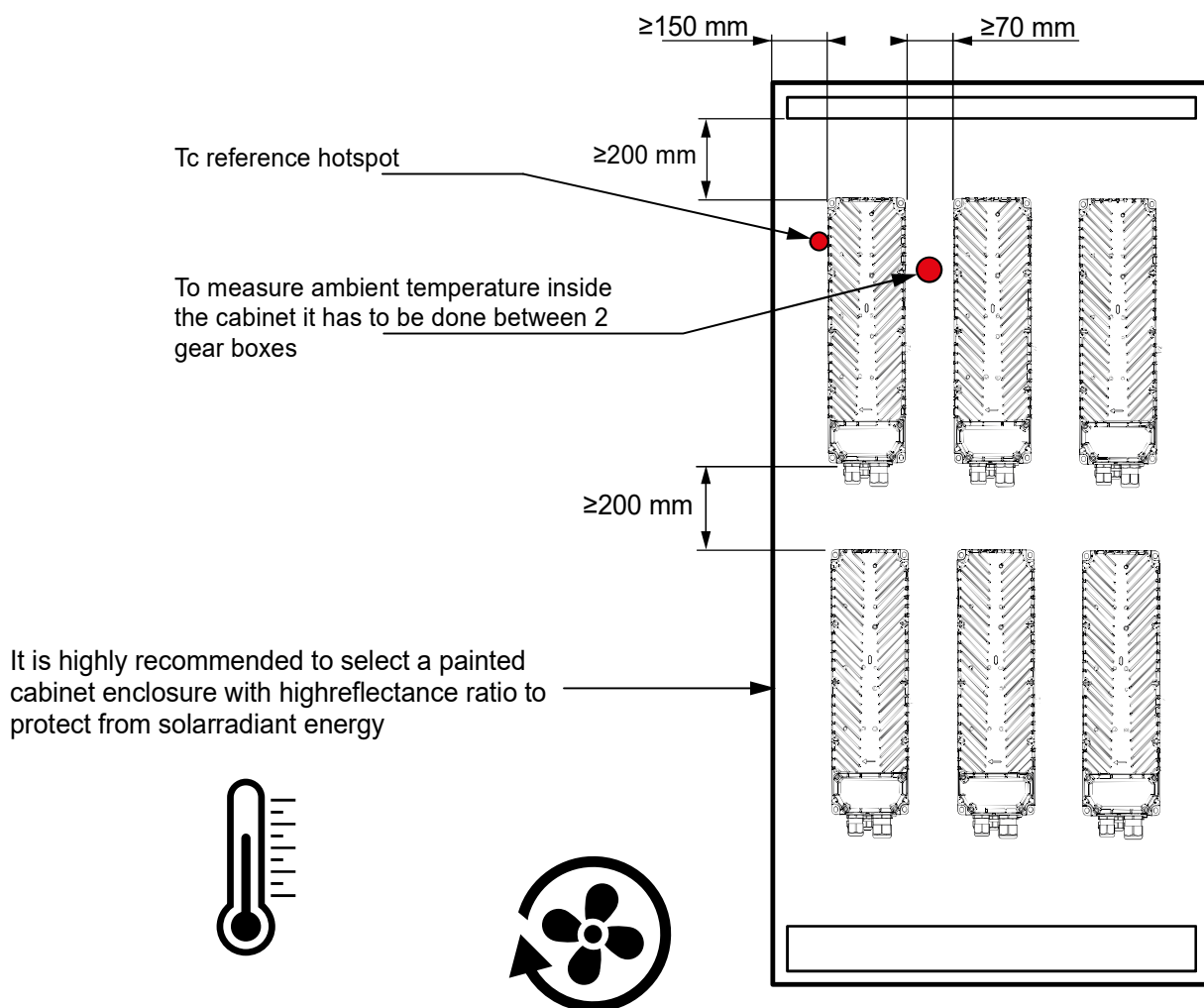

If you cannot follow instructions included in previous section regarding gear box integration, you have to measure Tc reference point taking into consideration that measures must be down to Tc\_max

Tc Reference at Max Ambient				
Position	Horizontal	Vertical	Side	
Mounting	<p>The diagram shows three gear box orientations: horizontal, vertical, and side. Red dots indicate the Tc measurement points. For the side view, a warning triangle with an exclamation mark is shown next to the gear box with the text 'This side up'.</p>			
	230Vac	81°C	80°C	82°C (Ref.)
	400Vac	69°C	68°C	70°C (Ref.)
	Ambient Max	55°C	55°C	55°C (Ref.)

# Aiming Device

96671487	ALTIS G4/G5 AIMING DEVICE WITH VISOR
96671488	ALTIS G4/G5 AIMING DEVICE BRACKET

ALDIS LED AIMING DEVICE THORN

UK Installation instructions FI Asennusohje LV Instalācijas instrukcijas  
 DE Montageanleitung FR Notice de montage NO Monteringsanvisning  
 CZ Montážní návod HU Szerelési útmutató PL Instrukcja montażu  
 DK Monteringsvejledning IT Istruzioni di montaggio SE Installationsanvisning  
 EE Paigaldusjuhend LT Montavimo instrukcija RU Инструкция по монтажу

ALDIS LED AIMING DEVICE

⚠ Don't forget to switch off the aiming device between each setup.

2x Aiming device  
 2x Strap  
 2x Cleaning cloth  
 2x Lens caps  
 4x CR1620 battery  
 2x Allen wrench  
 2x Instruction leaflet

⚠ Aiming device should be attached with strap supplied in doing mouse first.

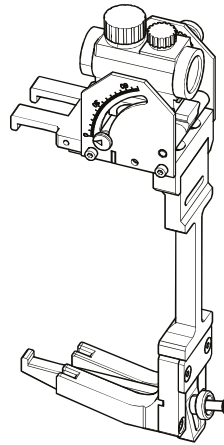

# Louvers / Bird Deterrent

ALDIS LED THORN

UK Installation instructions FI Asennusohje LV Instalācijas instrukcijas  
 DE Montageanleitung FR Notice de montage NO Monteringsanvisning  
 CZ Montážní návod HU Szerelési útmutató PL Instrukcja montażu  
 DK Monteringsvejledning IT Istruzioni di montaggio SE Installationsanvisning  
 EE Paigaldusjuhend LT Montavimo instrukcija RU Инструкция по монтажу

TYPE: ALTIS LED G4/G5 ACCESSORIES

Louvre A4/A5/A6/A6I  
 Louvre NB/EB/MB/WB  
 Bird Deterrent

Louvre A4/A5/A6/A6I

Louvre NB/EB/MB/WB



Bird Deterrent

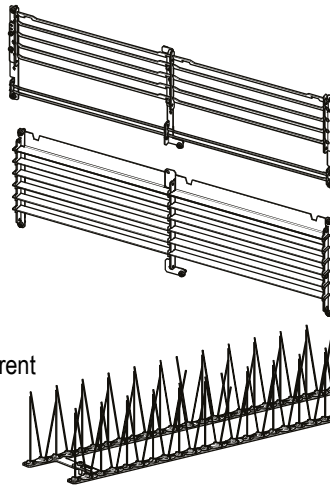

96671492	ALTIS G4/G5 1 BRICK LOUVRE A4
96671493	ALTIS G4/G5 1 BRICK LOUVRE A5
96671494	ALTIS G4/G5 1 BRICK LOUVRE A6/A6I
96671496	ALTIS G4/G5 1 BRICK LOUVRE MB
96671495	ALTIS G4/G5 1 BRICK LOUVRE NB/EB
96671497	ALTIS G4/G5 1 BRICK LOUVRE WB

96671489 ALTIS G4/G5 BIRD DETERRENT

# Visor

ALDIS LED THORN

UK Installation instructions FI Asennusohje LV Instalācijas instrukcijas  
 DE Montageanleitung FR Notice de montage NO Monteringsanvisning  
 CZ Montážní návod HU Szerelési útmutató PL Instrukcja montażu  
 DK Monteringsvejledning IT Istruzioni di montaggio SE Installationsanvisning  
 EE Paigaldusjuhend LT Montavimo instrukcija RU Инструкция по монтажу

TYPE: ALTIS G4/G5 ACCESSORIES

ALTIS G4/G5 VISOR

96671498 ALTIS G4/G5 1 BRICK AJ VISOR

Visor G4/G5

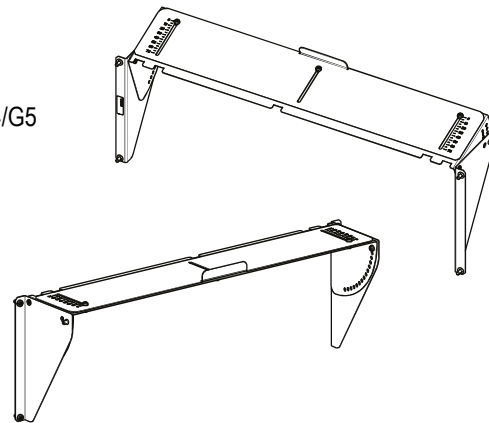

# Power supply support

ALDIS LED THORN

UK Installation instructions FI Asennusohje LV Instalācijas instrukcijas  
 DE Montageanleitung FR Notice de montage NO Monteringsanvisning  
 CZ Montážní návod HU Szerelési útmutató PL Instrukcja montażu  
 DK Monteringsvejledning IT Istruzioni di montaggio SE Installationsanvisning  
 EE Paigaldusjuhend LT Montavimo instrukcija RU Инструкция по монтажу

TYPE: ALTIS G4/G5 ACCESSORIES

96671490 ALTIS G4/G5 GB BRACKET 3 BRICK STIRRUP

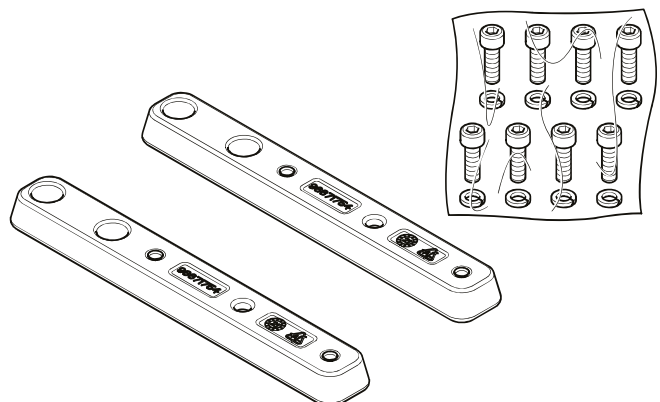

## FRANCAIS

-Remplacer toute protection fissurée.  
-Les luminaires classe II doivent être installés de façon à ce que la partie métallique ne soit pas en contact avec l'installation électrique connectée à la terre.

**ATTENTION:** Les luminaires classe I doivent être reliés à la terre.

-Ce luminaire fonctionne à une tension nominale qui doit être coupée avant toute intervention sur l'appareillage.  
-Toute modification de cet appareil est interdite.  
-Respecter la distance minimale par rapport aux objets éclairés définie par ce sigle.

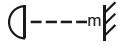

## SVERIGE

-Ersätta alla spräckta skyddsplåtar.  
-Klass II armaturer måste installeras så att nakna metalldelar i armaturen inte är i kontakt med någon elektrisk installation, kopplad till en skyddledare.

**VARNING:** Klass I armaturer måste vara jordade.

-Denna armatur fungerar med högspänning som måste vara frånslagen före ingripande i driftdonen.  
-Alla ändringar i denna armatur är förbjuden.

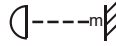

## ITALIANO

-Sostituire sempre tutte le protezioni danneggiate.  
-Gli apparecchi in classe II devono essere installati in modo che le parti metalliche non siano in contatto con apparati elettrici collegati a terra.

**ATTENZIONE:** Gli apparecchi in class I devono essere collegati a terra.

-Questo apparecchio funziona a tensione nominale, questa deve essere interrotta prima di ogni intervento sul gruppo di alimentazione.  
-Ogni modifica dell' apparecchio è proibita.

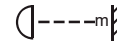

## ENGLISH

-Replace any cracked protective shield.  
-Class II luminaires must be installed so that exposed metal work of the luminaire is not in contact with any part of the electrical installation connected to a protective conductor.

**WARNING:** Class I luminaires must be earthed.

-This luminaire operates at mains voltage which must be switched off before intervention in control gear.  
-Any modification to this luminaire is forbidden.  
-Lighted objects nearer than the minimal distance in the is forbidden.

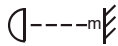

## DEUTSCH

-Ersetze jede gebrochene Schutzscheibe.  
-Schutzklasse II Leuchten müssen so installiert werden, daß berührbare Metallteile nicht mit einem, an dem Schutzleiter angeschlossenen Teil der elektrischen Installation in Kontakt kommen können.

**ACHTUNG:** Schutzklasse I Leuchten müssen geerdet sein.

-Diese Leuchte wird mit Netzspannung betrieben. Bevor Eingriffe am Vorschaltgerät vorgenommen werden sowie vor Wartung und Installation, ist die Versorgungsspannung abzuschalten.  
-Jede Änderung an dieser Leuchte ist verboten.

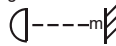

## SUOMI

-Rikkoontunut suojalasi vaihdettava välittömästi uutsen vastaavaan.  
-Asennettaessa suojausluokan II valaisinta on peruseristetyin johdon ja kosketeltävien metalliosien välinen kosketus tehokkaasti eristettävä.

**VAROITUS:** Suojausluokan I valaisin täytyy maadoittaa.

-Verkköjännite on kytkettävä pois ennen valaisimen huoltotoimenpiteitä.  
-Valaisimen rakennetta ei saa muuttaa.

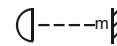

Thorn Lighting is constantly developing and improving its products. The right is reserved to change specifications without prior notification or public announcement.

© Thorn Lighting



- To ensure maintaining the best system performances, we advice to switch on the system "At least one night hour per month".