

Technical Information



Design

BSEN40, PD6547: 2004+A1: 2009 (No Sign)
 Load Class B
 Deflection Class 3

Head load - See Table

Finish

Galvanised to BSEN 1461:2022

Welding

In accordance with BSEN1011
 Procedures to BSEN ISO 15614-1:2017
 Welders qualified to BSEN ISO 9606-1:2017

* Maximum design head load based on wind loading region with orientation of bracket/luminaire(s) being on the same plane as door

Approximate Column Weight: 62kg

96632707

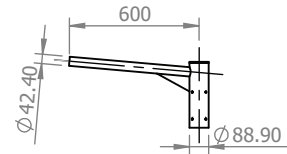
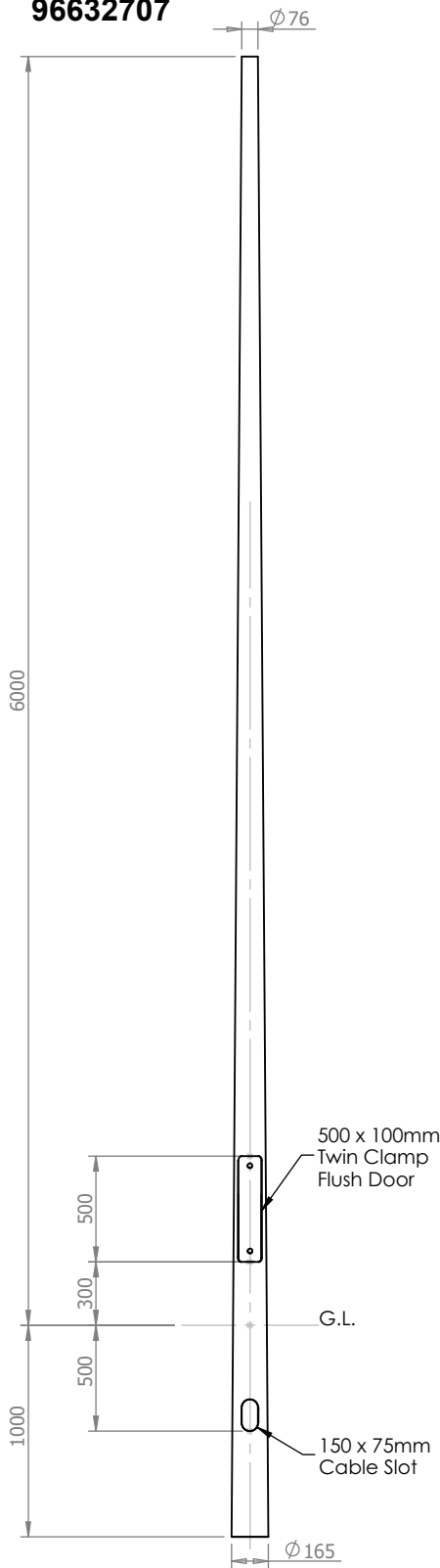

96632716 - Single Arm Bracket
 Approx Weight: 5.23kg

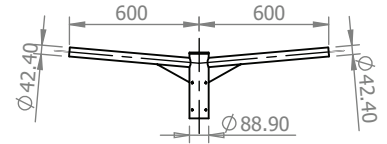

96632717 - Twin Arm Bracket
 Approx Weight: 7.36kg

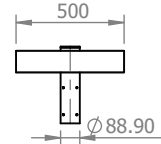

96632720 - Single Flood Light Bracket
 Approx Weight: 6.22kg

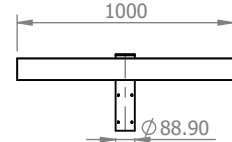

96632721 - Double/Quad Flood Light Bracket
 Approx Weight: 9.62kg

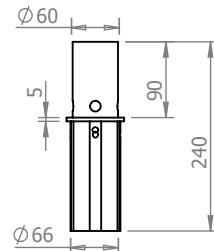

96633562 - 60mm Post Top Adaptor
 Approx Weight: 1kg

| Maximum Loading Including Bracket | | |
|-----------------------------------|------------------|--------------------------|
| Wind Loading Region | Terrain Category | Weight/Area |
| Extra Light | II | 110kg/0.82m ² |
| | III | 120kg/1.07m ² |
| Light | II | 100kg/0.72m ² |
| | III | 110kg/0.93m ² |
| Medium | II | 90kg/0.66m ² |
| | III | 100kg/0.84m ² |
| Heavy | II | 80kg/0.61m ² |
| | III | 90kg/0.78m ² |
| Extra Heavy | II | 70kg/0.48m ² |
| | III | 80kg/0.61m ² |



Title

6 Metre Tapered/Conical Root Mounted Post Top Column

Drg No. 49375-0

Scale:1:35
 Sheet 1 of 1

Notes

All dimensions in millimetres unless stated otherwise.

When Multiple views are shown 3rd Angle Projection is assumed.