

THORN

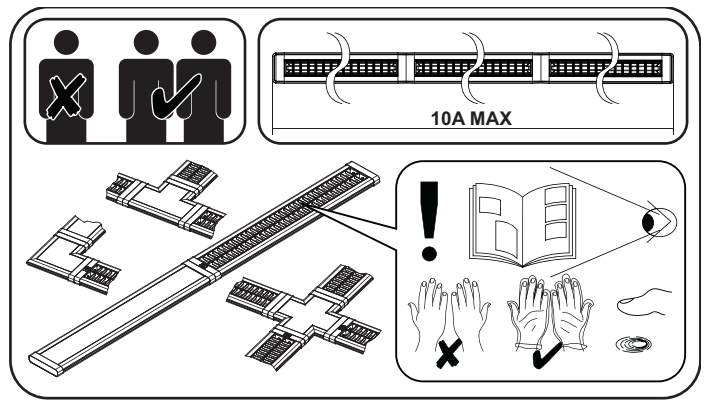
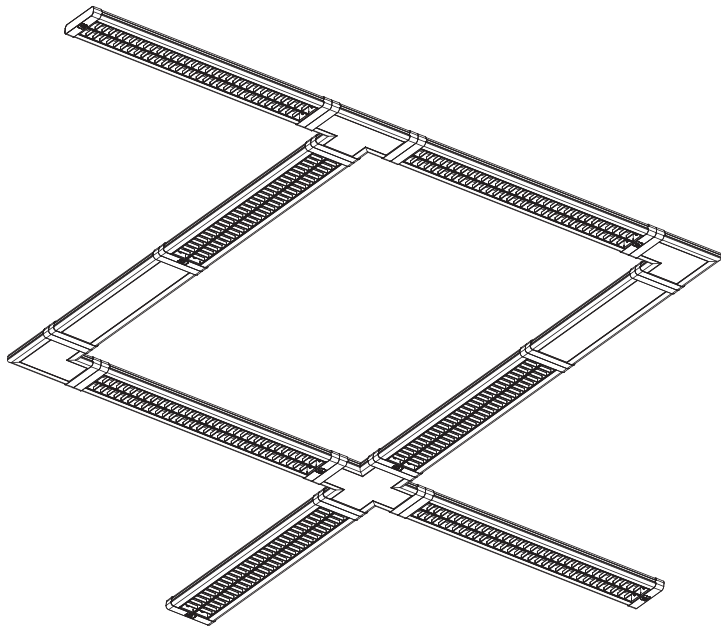

96552440 CONNECT KIT SINGLE LAMP
96552441 CONNECT KIT TWIN LAMP

PART NO.	DESCRIPTION	DIRECT (D)	INDIRECT (ID)	QTY
1	96342263(S)/96342264(T)	✓	✓	1
2	96341207	✓	✓	1
3	96342818	✓	✓	2
4	96342824	✓	✓	4
5	96300912	✓	✓	2
6	96301023	✓	✓	2
7	96308651	✓	✓	2
8	96305266	✓	✓	2

Contour System

CE

[CZ] Montážní návod
[DE] Montageanleitung
[DK] Monteringsvejledning
[EE] Paigaldusjuhend
[FI] Asennusohje
[FR] Notice de montage
[HU] Szerelési útmutató
[IT] Istruzioni di montaggio

[LT] Montavimo Instrukcijos
[LV] Instalācijas instrukcija
[NO] Monteringsanvisning
[PL] Instrukcja montażu
[RU] Инструкция по монтажу
[SE] Installationsanvisning
[UK] Installation Instructions

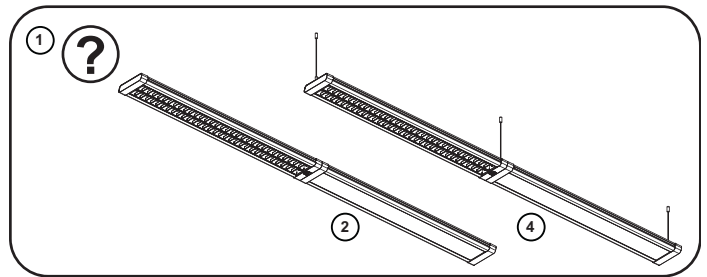

2

HF/HFI	A(mm)
28/54W	700
35/49W	1000
600 infill	-
900 infill	500
1200 infill	700

4

HF/HFI	28/54W	35/49W
28/54W	1180.5mm	1480.5mm
28/54W	1246mm	1546mm
600 infill	-	-
900 infill	600mm	900mm
1200 infill	600mm	1200mm

3

HF/HFI	B(mm)	
	28/54W	35/49W
28/54W	546	546
35/49W	-	546
600 infill	573	573
900 infill	473	473
1200 infill	523	523

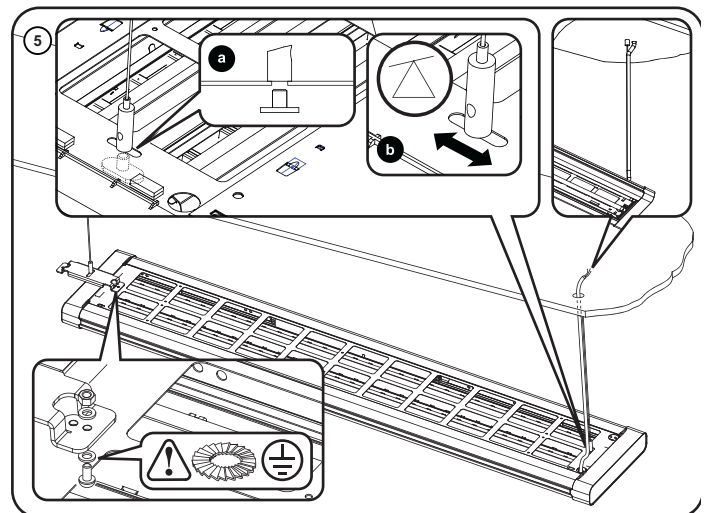

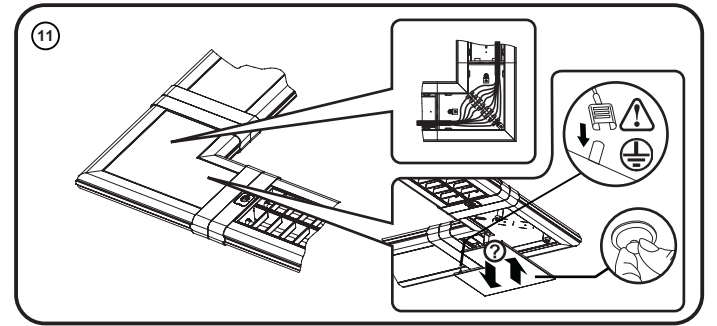
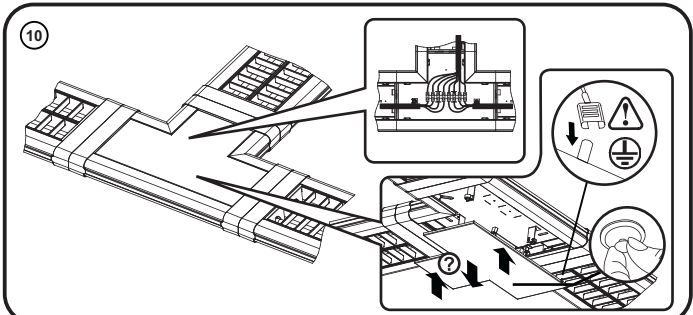
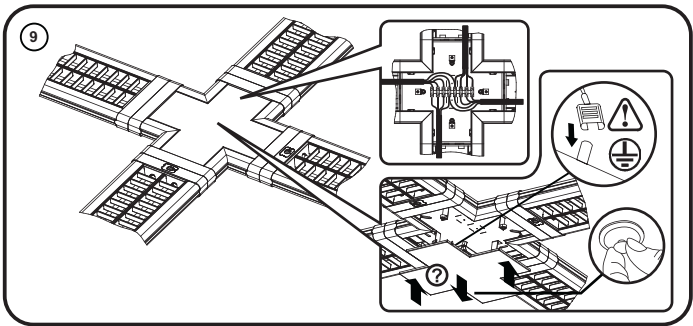
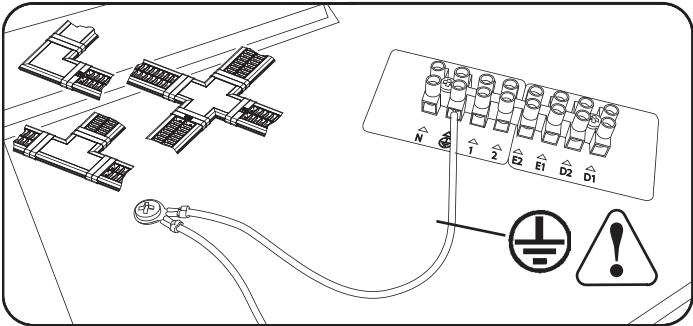
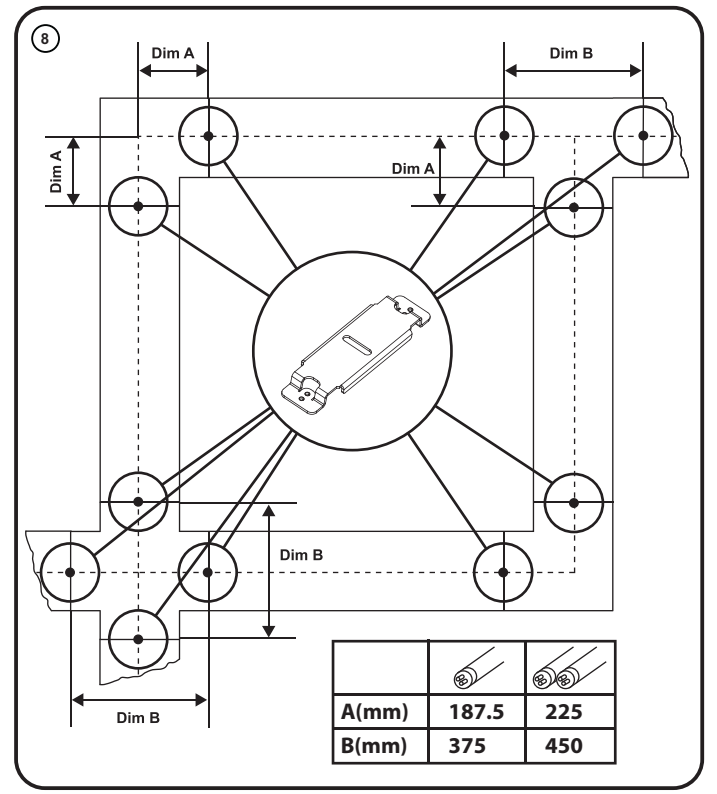
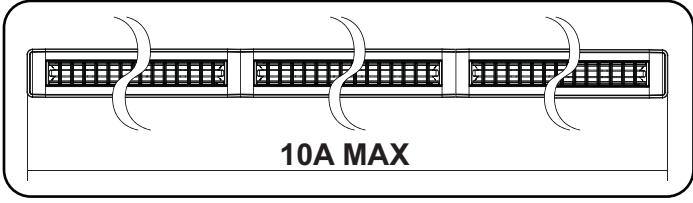
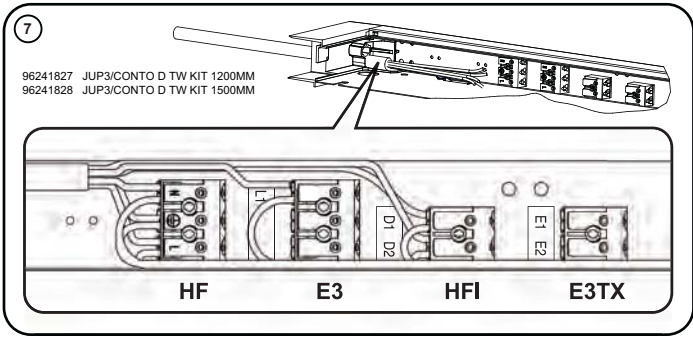
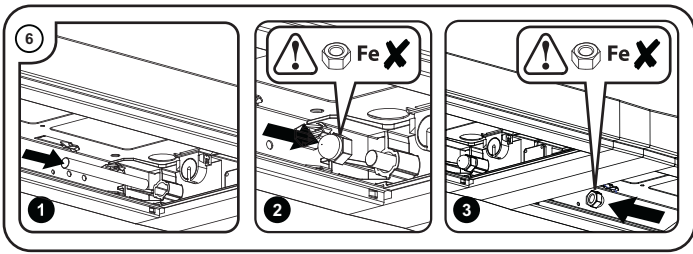

Maintenance and disassembly instruction sheet
Entretien et feuille d'instruction de démontage
Underhålls- och demonteringsinstruktion

