

7 WIDE / SLIM MPL (BS or MAS) / SLIM MGR

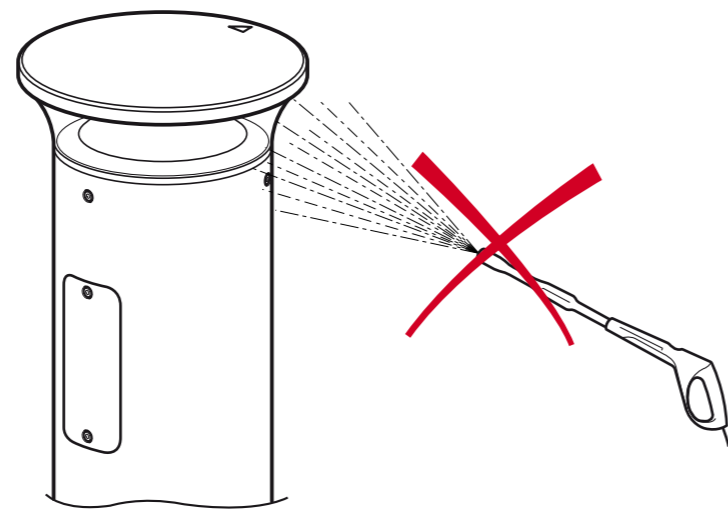
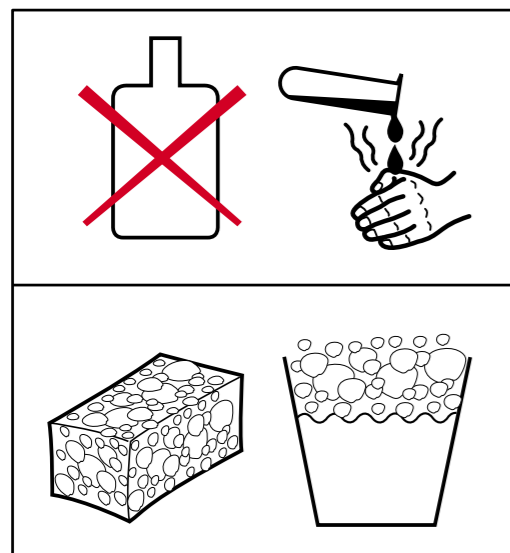
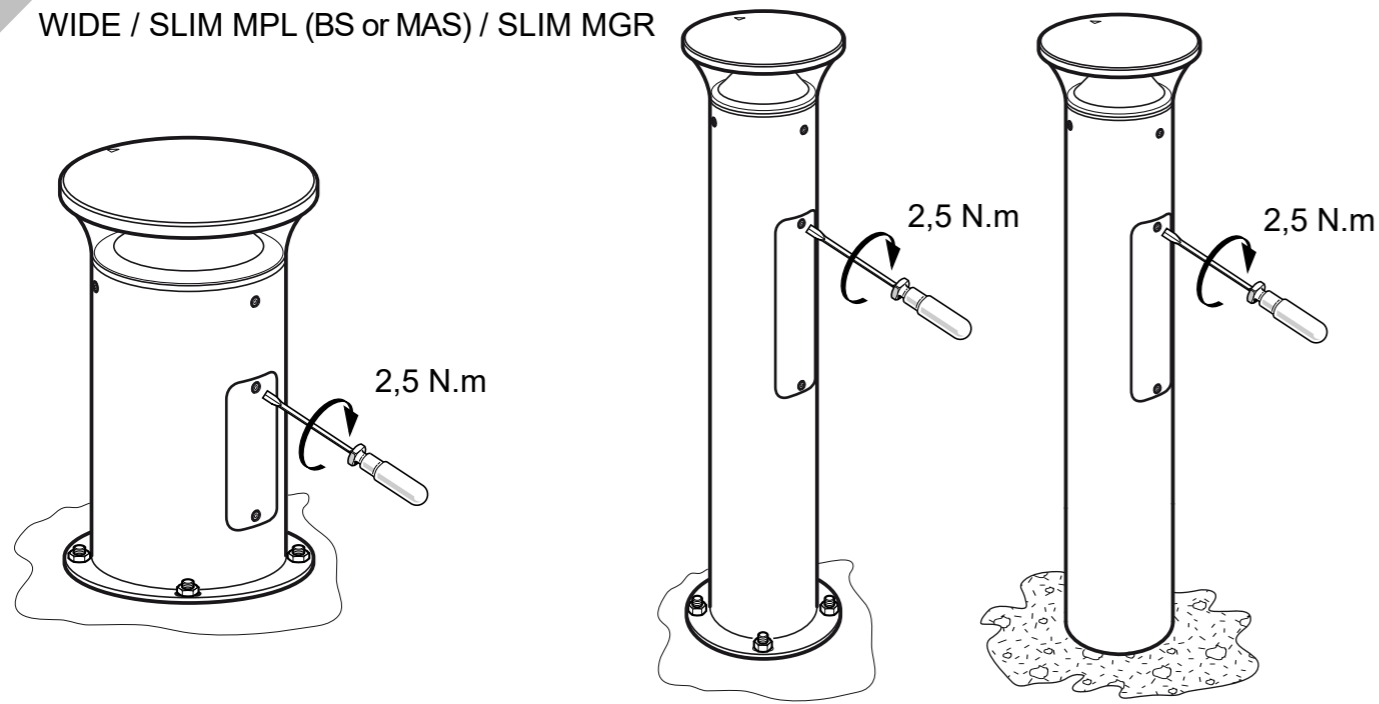

THOR BOLLARD

THORN

UK Installation instructions

FI Asennusohje

LV Instalācijas instrukcija

DE Montageanleitung

FR Notice de montage

NO Monteringsanvisning

CZ Montážní návod

HU Szerelési útmutató

PL Instrukcja montażu

DK Monteringsvejledning

IT Istruzioni di montaggio

SE Installationsanvisning

EE Paigaldusjuhend

LT Montavimo Instrukcijos

RU ИНСТРУКЦИЯ ПО МОНТАЖУ

TYPE : THOR BOLLARD WIDE
THOR BOLLARD SLIM MPL
THOR BOLLARD SLIM MGR

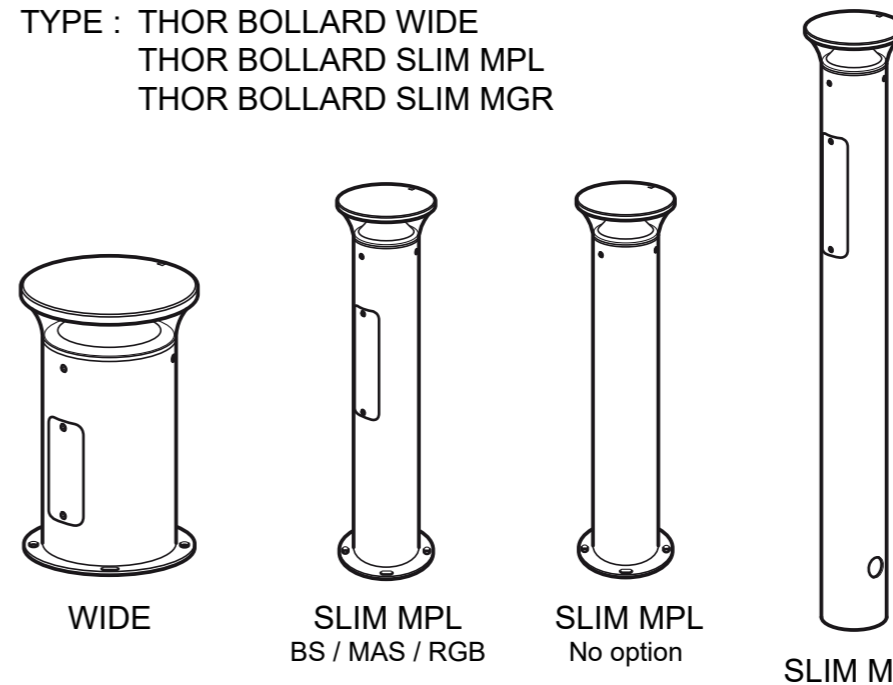

La source lumineuse contenue dans ce luminaire ne doit être remplacée que par le fabricant ou son agent de maintenance ou une personne de qualification équivalente.

The light source contained in this luminaire shall only be replaced by the manufacturer or his service agent or a similar qualified person

Caution, risk of electric shock
Danger, risque de chocs électriques

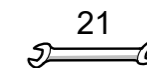

T30 creux / hollow

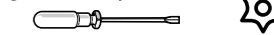

H4 creux / hollow



CLASS I

CLASS II

IK10

IP66

CE

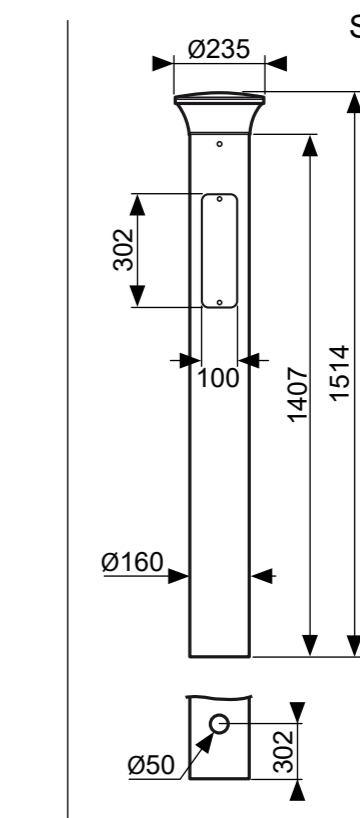
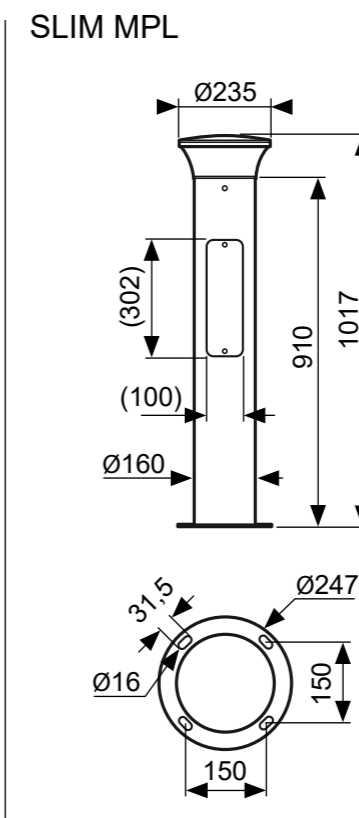
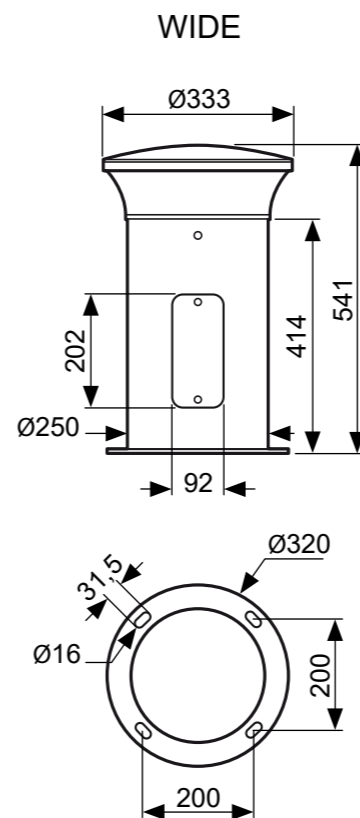

THOR BOLLARD	
	(kg)
WIDE	9.0
SLIM MPL	7.7
SLIM MGR	9.3

